

- 福建安波电机集团有限公司  
 ABLE ELECTRIC MOTOR GROUP CO., LTD.  
 地址: 福建省福安市秦溪洋工业区  
 Add: Qingxiyang Industrial Zone, Fuan City, Fujian Province, China  
 电话: 400-6511-039  
 Tel: 400-6511-039
- 安波电机(宁德)有限公司  
 ABLE ELECTRIC (NINGDE) CO., LTD.  
 地址: 宁德市东侨经济开发区漳湾工业园金湾路9号  
 Add: No.9, Jinwan Road, Zhangwan Industrial Zone, Dongqiao Economic Development Area, Ningde City, Fujian Province  
 电话: 0593-6161251  
 Tel: +86-593-6161251
- 上海汇波智能控制设备股份有限公司  
 SHANGHAI HOPE ELECTRIC MOTOR & CONTROL CO., LTD  
 地址: 浦东新区祝桥镇卫亭路158号  
 Add: No. 158 Wei Ting Road, Pudong New Area, Shanghai  
 电话: 021-58102208转8403  
 Tel: 021-58102208 ext. 8403
- 福安市闽东安波电器有限公司  
 FUAN ABLE ELECTRIC CO., LTD.  
 地址: 福建省福安市秦溪洋工业园区  
 Add: Qingxiyang Industrial Zone, Fuan City, Fujian Province, China  
 电话: +86-593-6510788  
 Tel: +86-593-6510788



[www.ablecn.com](http://www.ablecn.com)

[marketing@ablecn.com](mailto:marketing@ablecn.com)



# Aluminum/Cast iron Low Voltage Motor Specification

## 铝壳/铸铁壳低压电机



ISO9001 ISO14001 OHSAS18001



Aluminum/Cast iron





[www.ablecn.com](http://www.ablecn.com)

Able Electric Motor Group., Ltd. was established in 1993. It is a leading enterprise of the small and medium-sized motor and one of the top three aluminum housing motor manufacturers in China. It integrates R&D, production and sales together and own three manufacturing bases, Able Electric Motor (Ningde) Co., Ltd., Shanghai Hope Electric Motor & Control Co., Ltd., and Fu'an Able Electric Co., Ltd. The company has achieved ISO9001, ISO14001, and OHSAS 18001 management system certificates and CNAS laboratory accreditation certificate.

The company mainly produced single and three phase induction motor, three phase permanent magnet synchronous motor, brake motor, variable pole multi-speed motor, BLDC motor and tailor-made motor according to customer special requirements. The products have achieved CE, UKCA, UL, CSA, KC, CCC and China energy conservation certification, etc. Able can supply high efficiency motor of IE3, IE4 and IE5 according to new efficiency standard. Able motor products has features of energy saving, good performance, high reliability, and low noise, etc. The products have been used for centrifugal water supply pump, piping pump, metering pump, chemical pump, swimming pool circulation pump, vacuum pump, blower, gear reducer, air compressor, crane, mining machinery, engineering machinery, textile machinery, hydraulic equipment and automation equipment, etc. that widely used in industry, agriculture, commercial and residential fields.

Able motor has developed stable and reliable partnership with many customers including global top 500, multinational companies and leading enterprises of each field. Able motor products sell well in domestic market and more than 30 countries and regions in the world. All staffs of Able group sincerely welcome the friends all over the world come to negotiate cooperation.

安波电机集团创建于1993年，是中国中小电机龙头企业 and 三大铝壳电机生产厂家之一，集研发、生产、销售为一体，拥有安波电机（宁德）有限公司、上海汇波智能控制设备股份有限公司、福安市闽东安波电器有限公司三个生产基地。公司通过了ISO9001、ISO14001、OHSAS18001等管理体系认证和CNAS实验室资质认可。

公司的主要产品系列有单、三相交流异步电机、高效永磁同步电机、电磁制动电机、双速电机、无刷直流电机等，并根据客户要求定制化开发。公司产品拥有欧盟CE、英国UKCA、美国UL、加拿大CSA、韩国KC、中国CCC以及高效节能产品认证等，安波电机可按照新的电机能效标准提供IE3、IE4和IE5的高效节能产品，具有高效节能、性能优异、运行可靠、噪音低等特点，广泛应用于楼宇供水水泵、管道泵、计量泵、化工泵、泳池循环泵、真空泵、风机、减速机、空压机、起重机械、矿山机械、工程机械、纺织机械、液压设备、自动化设备等工业、农业、商业和民用领域。

公司通过优质的产品和服务已经成为许多世界500强、跨国公司和行业领先企业的长期合作伙伴，产品畅销全国并出口到世界三十多个国家和地区。安波电机全体员工竭诚欢迎各界新老朋友到安波参观洽谈协商合作。



▪ 宁德工厂 Ningde Factory



▪ 上海市工厂 Shanghai Factory



▪ 福建福安工厂 FuAn Factory



多年来在各级领导关心支持下，在国内外各界朋友支持爱护下，公司坚持“为顾客提供一流产品，为员工提供发展空间，共同创造社会繁荣”为宗旨，打造“负责使人更信任”的核心价值观，实施“以科技为先导、以品质求发展，为员工谋福利”的战略步骤而迅速发展。

只要相聚就会有收获，安波愿以自己的真诚和实力成为您的忠实朋友！

With the years of care and support of leaders at all levels and friends from all walks of life at home and abroad, ABLE develops rapidly by adhering to the aim of "provide customers with first-class products, provide development space for employees, and create social prosperity jointly", building core value of "responsibility creates trust", and implementing the strategic steps of "science and technology as the guide, develop with quality, and seek benefits for employees".



宁静致远，安波电机  
 核心价值观：负责、分享、创新、包容  
 我们的使命：让电机科技驱动社会进步  
 我们的愿景：使安波成为电机应用行业细分市场的领导者

Be quiet, Be permanent  
 Core Value: Responsible, Sharing, Innovative, Tolerant  
 Mission: ABLE motor motivates the social improvement  
 Vision: To be a leader in niche market of motor application



**ABLE**<sup>®</sup>  
 ABLE MOTOR  
[www.ablecn.com](http://www.ablecn.com)



ISO9001、ISO14001、OHSAS18001三体系证书  
 ISO9001、ISO14001、OHSAS18001 Management System Certificates  
 CNAS实验室资质认可  
 CNAS Laboratory Accreditation Certificates



产品认证 Product Certificates



UKCA      CE-IE3(EMC)      CCC YE3(中文)      CCC YE3(英文)



KC      BV      CE      UL



IE4节能证书  
 IE4 Energy Conservation Certificates  
 IE4中国能效标识  
 IE4 China Energy Label

产品主要应用领域  
 Main Applications of Motor



楼宇供水  
 Building water supply



减速机  
 Gear reducer



起重机械  
 Crane



畜牧风机  
 Animal husbandry circulation fan



喷涂机  
 Spraying equipment



液压设备  
 Hydraulic equipment



真空泵  
 Vacuum pump



地坪研磨  
 Floor grinding equipment



纺织机械  
 Textile machinery



空压机  
 Air compressor



石材机械  
 Stone machinery



风力发电  
 Wind power generation

# 目录 CONTENT

Y2系列（铸铁壳）三相异步电动机  
Y2 series cast iron three phase induction motor

Y2HE系列（铸铁壳）三相异步电动机  
Y2HE series cast iron three phase induction motor

YE3系列（铸铁壳）三相异步电动机  
YE3 series cast iron three phase induction motor

YE3系列（铸铁壳）韩国市场三相异步电动机  
YE3 series cast iron three phase induction motor for South Korean market

YE4系列（铸铁壳）三相异步电动机  
YE4 series cast iron three phase induction motor

TYT4系列（铸铁壳）三相永磁同步电动机  
TYT4 series cast iron three phase permanent magnet synchronous motor

YD系列（铸铁壳）变极多速三相异步电动机  
YD series cast iron variable pole multi-speed three phase induction motor

## Y2/Y2HE系列铸铁壳三相异步电动机 Y2/Y2HE SERIES CAST IRON THREE PHASE INDUCTION MOTOR IE1 IE2

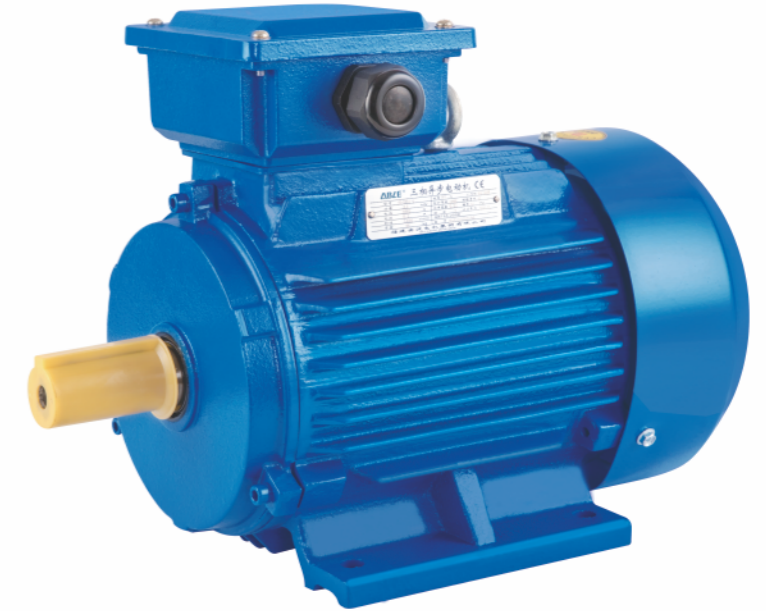

### 产品简介

该系列电机是专为欧洲市场设计的三相异步电机，电机出线盒置于电机壳顶部，整机机构紧凑、外形美观大方，安装尺寸符合IEC标准，F级绝缘、B级温升考核，具有高效、节能、起动转矩大，使用维护方便等特点。

### 使用条件

- 绝缘等级: F
- 防护等级: IP54/IP55
- 额定电压: 根据客户需求
- 额定频率: 50Hz/60Hz
- 冷却方式: IC411
- 工作制: S1

### 安装结构

- B3机座带底脚，端盖无凸缘
- B35机座带底脚，端盖有凸缘
- B5机座无底脚，端盖有凸缘

### PRODUCT INTRODUCTION

- Three-phase asynchronous motors
- Designed specifically for European market
- Terminal box is at the top of motor housing
- Compact structure and beautiful appearance
- Installation dimensions meet IEC standard
- Grade F insulation
- Grade B temperature rise test
- High efficiency, energy saving, and large starting torque
- Easy to use and maintain

### APPLICATION CONDITIONS

- Insulation grade: F
- Protection grade: IP54/IP55
- Rated voltage according to customer's request
- Rated frequency: 50Hz/60Hz
- Cooling method: IC411
- Duty type: S1

### INSTALLATION STRUCTURE

- B3 base with feet; end shields without flange
- B35 base with feet; end shields with flange
- B5 base without feet; end shields with flange

**ABLE**<sup>®</sup>  
ABLE MOTOR

[www.ablecn.com](http://www.ablecn.com)

# Y2/Y2HE系列铸铁壳三相异步电动机

## Y2/Y2HE SERIES CAST IRON THREE PHASE INDUCTION MOTOR

IMB3

IMB35

IMB5

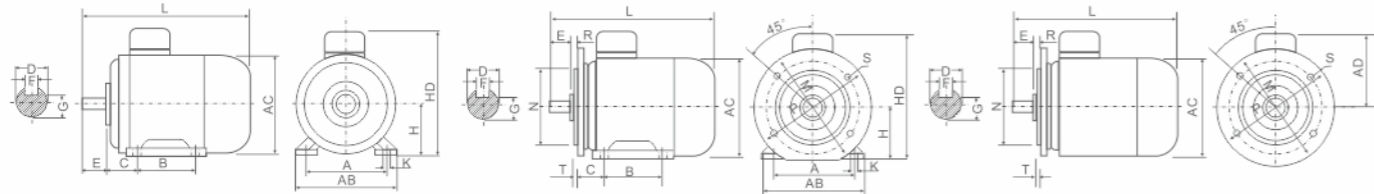

### 外形及安装尺寸 INSTALLATION AND OVERALL DIMENSIONS

机座号 Frame Size	安装尺寸 Mounting Dimensions (mm)																外形尺寸 Overall Dimensions(mm)								
	A	B	C	D		E		F		G		H	K	M	N	P	R	S	T	AB	AC	AD	HD	L	
				2P	4,6,8,10P	2P	4,6,8,10P	2P	4,6,8,10P	2P	4,6,8,10P													2P	4,6,8,10P
63	100	80	40	11	23	4	8.5	63	7	115	95	140	0	10	3	135	130	70	180	230					
71	112	90	45	14	30	5	11	71	7	130	110	160	0	10	3	150	145	80	195	255					
80	125	100	50	19	40	6	15.5	80	10	165	130	200	0	12	3.5	165	175	145	220	295					
90S	140	100	56	24	50	8	20	90	10	165	130	200	0	12	3.5	180	195	155	250	320					
90L	140	125	56	24	50	8	20	90	10	165	130	200	0	12	3.5	180	195	155	250	345					
100L	160	140	63	28	60	8	24	100	12	215	180	250	0	15	4	205	215	180	270	385					
112M	190	140	70	28	60	8	24	112	12	215	180	250	0	15	4	230	240	190	300	400					
132S	216	140	89	38	80	10	33	132	12	265	230	300	0	15	4	270	275	210	345	470					
132M	216	178	89	38	80	10	33	132	12	265	230	300	0	15	4	270	275	210	345	510					
160M	254	210	108	42	110	12	37	160	15	300	250	350	0	19	5	315	330	255	400	605					
160L	254	254	108	42	110	12	37	160	15	300	250	350	0	19	5	315	330	255	400	660					
180M	279	241	121	48	110	14	42.5	180	15	300	250	350	0	19	5	355	380	280	440	690					
180L	279	279	121	48	110	14	42.5	180	15	300	250	350	0	19	5	355	380	280	440	725					
200L	318	305	133	55	110	16	49	200	19	350	300	400	0	19	5	410	420	305	500	765					
225S	356	286	149	-	60	-	140	-	18	-	53	225	19	400	350	450	0	19	5	445	470	335	555	-	810
225M	356	311	149	55	60	110	140	16	18	49	53	225	19	400	350	450	0	19	5	445	470	335	550	805	835
250M	406	349	168	60	65	140	180	18	53	58	58	250	24	500	450	550	0	19	5	485	510	370	615	910	
280S	457	368	190	65	75	140	180	18	20	58	67.5	280	24	500	450	550	0	19	5	550	580	410	660	980	
280M	457	419	190	65	75	140	180	18	20	58	67.5	280	24	500	450	550	0	19	5	550	580	410	660	1030	
315S	508	406	216	65	80	140	170	18	22	58	71	315	28	600	550	660	0	24	6	630	645	630	825	1180	1275
315M	508	457	216	65	80	140	170	18	22	58	71	315	28	600	550	660	0	24	6	630	645	630	830	1290	1320
315L	508	508	216	65	80	140	170	18	22	58	71	315	28	600	550	660	0	24	6	630	645	630	830	1290	1320
355M	610	560	254	75	95	140	170	20	25	68	86	355	28	740	680	800	0	24	6	705	710	655	1010	1510	1540
355L	610	630	254	75	95	140	170	20	25	68	86	355	28	740	680	800	0	24	6	705	710	655	1010	1510	1540

### 技术参数 TECHNICAL DATA

IE1

型号 Model	额定功率 Rated Power		额定电流 Rated Current (A)									额定 转速 Speed rpm	额定 转矩 Tn N.m	效率 Eff. η(%)	功率 因数 PF cosφ	堵转转矩 Tst/Tn	最大转矩 Tmax/Tn	堵转电流 Ist/In	重量 N.G kg
	KW	HP	220V	380V	660V	230V	400V	690V	240V	415V	720V								
Y2-631-2	0.18	0.25	0.91	0.53	0.24	0.87	0.50	0.23	0.83	0.48	0.22	2760	0.62	65.0	0.80	3.0	3.2	5.0	7
Y2-632-2	0.25	0.35	1.19	0.69	0.32	1.14	0.66	0.31	1.09	0.63	0.29	2760	0.87	68.0	0.81	3.2	3.3	5.0	7.2
Y2-711-2	0.37	0.5	1.71	0.99	0.46	1.64	0.94	0.44	1.57	0.91	0.42	2800	1.26	70.0	0.81	2.8	3.0	5.0	9.7
Y2-712-2	0.55	0.75	2.41	1.40	0.66	2.31	1.33	0.63	2.21	1.28	0.60	2800	1.88	73.0	0.82	3.3	3.5	5.0	10.7
Y2-801-2	0.75	1	3.29	1.90	0.91	3.15	1.81	0.87	3.01	1.74	0.83	2890	2.48	72.1	0.83	2.8	3.8	7.0	16
Y2-802-2	1.1	1.5	4.58	2.65	1.28	4.38	2.52	1.23	4.20	2.43	1.18	2900	3.62	75.0	0.84	2.8	3.5	7.0	17
Y2-90S-2	1.5	2	6.07	3.51	1.70	5.81	3.34	1.63	5.56	3.22	1.56	2900	4.94	77.2	0.84	2.4	2.8	7.5	21
Y2-90L-2	2.2	3	8.52	4.93	2.41	8.15	4.69	2.31	7.81	4.52	2.21	2930	7.17	79.7	0.85	2.5	2.8	7.5	25
Y2-100L-2	3	4	11.1	6.43	3.22	10.6	6.11	3.08	10.1	5.89	2.95	2930	9.78	81.5	0.87	2.6	3.2	7.3	33
Y2-112M-2	4	5.5	14.3	8.30	4.21	13.7	7.90	4.03	13.1	7.61	3.86	2930	13.0	83.1	0.88	2.5	2.7	7.0	42
Y2-132S1-2	5.5	7.5	19.3	11.2	5.68	18.5	10.6	5.43	17.7	10.2	5.21	2940	17.9	84.7	0.88	2.6	3.0	7.8	64
Y2-132S2-2	7.5	10	26.0	15.0	7.63	24.8	14.3	7.30	23.8	13.7	6.99	2950	24.3	86.0	0.88	2.5	2.7	7.5	68
Y2-160M1-2	11	15	37.0	21.4	10.9	35.4	20.3	10.5	33.9	19.6	10.0	2950	35.6	87.6	0.89	2.7	3.0	7.8	106
Y2-160M2-2	15	20	49.8	28.8	14.7	47.7	27.4	14.1	45.7	26.4	13.5	2970	48.2	88.7	0.89	2.7	3.0	7.8	107
Y2-160M3-2	18.5	25	60.4	34.9	18.1	57.7	33.2	17.3	55.3	32.0	16.6	2970	59.5	89.3	0.90	2.7	3.0	7.8	117
Y2-160L-2	18.5	25	60.4	34.9	18.1	57.7	33.2	17.3	55.3	32.0	16.6	2970	59.5	89.3	0.90	2.7	3.0	7.8	130
Y2-180M-2	22	30	71.3	41.3	21.4	68.2	39.2	20.4	65.4	37.8	19.6	2970	70.7	89.9	0.90	3.2	3.5	8.0	152
Y2-180M2-2	30	40	96.4	55.8	28.9	92.2	53.0	27.6	88.4	51.1	26.5	2970	96.5	90.7	0.90	3.2	3.5	8.0	180
Y2-180L2-2	30	40	96.4	55.8	28.9	92.2	53.0	27.6	88.4	51.1	26.5	2970	96.5	90.7	0.90	3.2	3.5	8.0	195
Y2-200L1-2	30	40	96.4	55.8	28.9	92.2	53.0	27.6	88.4	51.1	26.5	2970	96.5	90.7	0.90	2.1	2.9	7.8	220
Y2-200L2-2	37	50	118	68.4	35.4	113	65.0	33.9	108	62.7	32.5	2980	118.6	91.2	0.90	2.2	2.9	7.8	230
Y2-200L3-2	45	60	143	82.8	42.9	136	78.7	41.0	131	75.8	39.3	2980	144.2	91.7	0.90	2.2	2.9	7.8	252
Y2-225M-2	45	60	143	82.8	42.9	136	78.7	41.0	131	75.8	39.3	2980	144.2	91.7	0.90	2.3	2.8	7.0	280
Y2-225M2-2	55	75	174	100	52.2	166	95.7	49.9	159	92.3	47.8	2980	176.3	92.1	0.90	2.3	2.8	7.0	310
Y2-250M-2	55	75	174	100	52.2	166	95.7	49.9	159	92.3	47.8	2980	176.3	92.1	0.90	2.2	2.8	7.5	366
Y2-250M2-2	75	100	235	136	70.7	225	129	67.7	216	125	64.8	2980	240.4	92.7	0.90	2.2	2.8	7.5	445
Y2-280S-2	75	100	235	136	70.7	225	129	67.7	216	125	64.8	2980	240.4	92.7	0.90	2.0	2.3	7.0	475
Y2-280M-2	90	125	279	161	84.6	266	153	80.9	255	147	77.6	2980	288.4	93.0	0.91	2.0	2.3	7.0	530
Y2-280M2-2	110	150	340	196	103	325	187	98.6	311	180	94.5	2980	352.5	93.3	0.91	2.0	2.3	7.0	600
Y2-315S-2	110	150	340	196	103	325	187	98.6	311	180	94.5	2980	352.5	93.3	0.91	2.0	2.3	6.8	850
Y2-315M-2	132	180	407	235	123	389	223	118	373	215	113	2980	423.0	93.5	0.91	2.0	2.3	6.8	930
Y2-315L1-2	160	220	486	281	149	465	267	142	446	257	136	2980	512.8	93.8	0.92	2.0	2.3	6.8	990
Y2-315L2-2	200	270	606	351	186	580	333	178	556	321	170	2980	640.9	94.0	0.92	2.0	2.3	6.8	1030
Y2-355M-2	250	340	758	439	232	725	417	222	695	402	213	2980	801.2	94.0	0.92	1.8	2.2	7.0	1650
Y2-355L-2	315	430	941	545	288	900	518	276	863	499	264	2980	1009.5	95.4	0.92	1.8	2.2	7.0	1750

# Y2/Y2HE系列铸铁壳三相异步电动机

## Y2/Y2HE SERIES CAST IRON THREE PHASE INDUCTION MOTOR



技术参数 TECHNICAL DATA

IE1

型号 Model	额定功率 Rated Power		额定电流 Rated Current (A)										额定 转速 Speed rpm	额定 转矩 Tn N.m	效率 Eff. η(%)	功率 因数 PF cosφ	堵转转矩 额定转矩 Tst/Tn	最大转矩 额定转矩 Tmax/Tn	堵转电流 额定电流 Ist/In	重量 N.G kg
	kW	HP	220V	380V	660V	230V	400V	690V	240V	415V	720V									
Y2-631-4	0.12	0.16	0.77	0.44	0.18	0.73	0.42	0.18	0.70	0.41	0.17	1350	0.85	57.0	0.72	2.2	2.2	4.5	7	
Y2-632-4	0.18	0.25	1.08	0.62	0.26	1.03	0.59	0.25	0.99	0.57	0.24	1350	1.27	60.0	0.73	2.2	2.2	4.5	7.2	
Y2-711-4	0.25	0.35	1.36	0.79	0.34	1.30	0.75	0.32	1.25	0.72	0.31	1370	1.74	65.0	0.74	2.4	2.8	4.5	8.4	
Y2-712-4	0.37	0.5	1.93	1.12	0.48	1.85	1.06	0.46	1.77	1.02	0.44	1370	2.58	67.0	0.75	2.4	2.8	4.5	9.7	
Y2-801-4	0.55	0.75	2.71	1.57	0.68	2.59	1.49	0.65	2.48	1.44	0.62	1400	3.75	71.0	0.75	2.4	2.6	5.0	16	
Y2-802-4	0.75	1	3.59	2.08	0.91	3.44	1.98	0.87	3.29	1.90	0.83	1400	5.12	72.1	0.76	2.4	2.6	5.0	17	
Y2-90S-4	1.1	1.5	5.00	2.89	1.28	4.78	2.75	1.23	4.58	2.65	1.18	1400	7.50	75.0	0.77	2.2	2.4	6.0	22	
Y2-90L-4	1.5	2	6.45	3.74	1.70	6.17	3.55	1.63	5.92	3.42	1.56	1400	10.2	77.2	0.79	2.2	2.4	6.0	26	
Y2-100L1-4	2.2	3	8.94	5.18	2.41	8.55	4.92	2.31	8.20	4.74	2.21	1420	14.8	79.7	0.81	2.2	2.3	7.0	33	
Y2-100L2-4	3	4	11.7	6.82	3.22	11.2	6.48	3.08	10.8	6.25	2.95	1420	20.2	81.5	0.82	2.2	2.3	7.0	36	
Y2-112M-4	4	5.5	15.4	8.92	4.21	14.7	8.47	4.03	14.1	8.17	3.86	1440	26.5	83.1	0.82	2.4	3.0	7.0	46	
Y2-132S-4	5.5	7.5	20.5	11.8	5.68	19.6	11.2	5.43	18.8	10.8	5.21	1440	36.5	84.7	0.83	2.8	3.2	7.5	64	
Y2-132M-4	7.5	10	27.2	15.7	7.63	26.0	14.9	7.30	24.9	14.4	6.99	1440	49.7	86.0	0.84	2.8	3.2	7.5	77	
Y2-132M2-4	9.2	12.5	32.8	19.0	9.20	31.4	18.0	8.80	30.1	17.4	8.43	1460	60.2	87.5	0.84	2.8	3.2	7.5	76	
Y2-160M-4	11	15	39.2	22.7	10.9	37.5	21.5	10.5	35.9	20.8	10.0	1460	72.0	87.6	0.84	2.4	3.5	7.5	106	
Y2-160L-4	15	20	52.2	30.2	14.7	49.9	28.7	14.1	47.8	27.6	13.5	1460	98.1	88.7	0.85	2.4	3.5	7.5	126	
Y2-180M-4	18.5	25	63.2	36.6	18.1	60.4	34.7	17.3	57.9	33.5	16.6	1470	120.2	89.3	0.86	2.3	2.8	7.5	154	
Y2-180L-4	22	30	74.6	43.2	21.4	71.4	41.0	20.4	68.4	39.5	19.6	1470	142.9	89.9	0.86	2.3	3.0	8.0	175	
Y2-180L2-4	30	40	100	58.4	28.9	96.5	55.5	27.6	92.5	53.5	26.5	1470	194.9	90.7	0.86	2.3	3.0	8.0	200	
Y2-200L-4	30	40	100	58.4	28.9	96.5	55.5	27.6	92.5	53.5	26.5	1470	194.9	90.7	0.86	2.3	2.8	7.5	235	
Y2-200L2-4	37	50	122	70.8	35.4	117	67.3	33.9	112	64.8	32.5	1480	238.8	91.2	0.87	2.3	2.8	7.5	250	
Y2-225S-4	37	50	122	70.8	35.4	117	67.3	33.9	112	64.8	32.5	1480	238.8	91.2	0.87	2.3	2.6	7.5	295	
Y2-225M-4	45	60	148	85.7	42.9	141	81.4	41.0	135	78.4	39.3	1480	290.4	91.7	0.87	2.3	2.6	7.5	306	
Y2-225M2-4	55	75	180	104	52.2	172	99.0	49.9	165	95.4	47.8	1480	354.9	92.1	0.87	2.3	2.6	8.0	340	
Y2-250M-4	55	75	180	104	52.2	172	99.0	49.9	165	95.4	47.8	1480	354.9	92.1	0.87	2.2	2.5	7.0	375	
Y2-250M2-4	75	100	244	141	70.7	233	134	67.7	223	129	64.8	1480	484.0	92.7	0.87	2.2	2.5	7.0	490	
Y2-280S-4	75	100	244	141	70.7	233	134	67.7	223	129	64.8	1480	484.0	92.7	0.87	2.3	2.8	7.0	533	
Y2-280M-4	90	125	291	169	84.6	279	160	80.9	267	154	77.6	1480	580.7	93.0	0.87	2.3	2.8	7.0	575	
Y2-280M2-4	110	150	351	203	103	336	193	98.6	322	186	94.5	1490	705.0	93.3	0.88	2.3	2.8	7.0	685	
Y2-315S-4	110	150	351	203	103	336	193	98.6	322	186	94.5	1490	705.0	93.3	0.88	2.3	2.5	7.0	820	
Y2-315M-4	132	180	421	243	123	402	231	118	385	223	113	1490	846.0	93.5	0.88	2.3	2.5	7.0	960	
Y2-315L1-4	160	220	502	291	149	481	276	142	461	266	136	1490	1025.5	93.8	0.89	2.3	2.5	7.0	1000	
Y2-315L2-4	200	270	627	363	186	600	345	178	575	332	170	1490	1281.9	94.0	0.89	2.3	2.5	7.0	1080	
Y2-355M-4	250	340	775	448	232	741	426	222	710	411	213	1485	1607.7	94.0	0.90	2.3	2.5	6.8	1580	
Y2-355L-4	315	430	964	558	289	922	530	276	884	511	265	1485	2025.8	95.2	0.90	2.2	2.5	6.9	1730	

技术参数 TECHNICAL DATA

IE1

型号 Model	额定功率 Rated Power		额定电流 Rated Current (A)										额定 转速 Speed rpm	额定 转矩 Tn N.m	效率 Eff. η(%)	功率 因数 PF cosφ	堵转转矩 额定转矩 Tst/Tn	最大转矩 额定转矩 Tmax/Tn	堵转电流 额定电流 Ist/In	重量 N.G kg
	kW	HP	220V	380V	660V	230V	400V	690V	240V	415V	720V									
Y2-711-6	0.18	0.25	1.28	0.74	0.28	1.22	0.70	0.27	1.17	0.68	0.26	880	1.95	56.0	0.66	2.3	2.5	3.5	8	
Y2-712-6	0.25	0.35	1.64	0.95	0.37	1.56	0.90	0.35	1.50	0.87	0.34	880	2.71	59.0	0.68	2.3	2.5	3.5	8.4	
Y2-801-6	0.37	0.5	2.24	1.30	0.52	2.14	1.23	0.50	2.05	1.19	0.48	900	3.93	62.0	0.70	2.2	2.4	4.0	17	
Y2-802-6	0.55	0.75	3.08	1.79	0.74	2.95	1.70	0.71	2.83	1.63	0.68	900	5.84	65.0	0.72	2.2	2.4	4.0	19	
Y2-90S-6	0.75	1	3.91	2.26	0.94	3.74	2.15	0.90	3.58	2.07	0.86	910	7.87	70.0	0.72	2.2	2.5	4.5	22	
Y2-90L-6	1.1	1.5	5.42	3.14	1.32	5.19	2.98	1.26	4.97	2.88	1.21	910	11.5	72.9	0.73	2.2	2.5	4.5	24	
Y2-100L-6	1.5	2	6.98	4.04	1.74	6.68	3.84	1.67	6.40	3.70	1.60	940	15.2	75.2	0.75	2.2	2.8	6.0	31	
Y2-112M-6	2.2	3	9.78	5.66	2.48	9.35	5.38	2.37	8.96	5.18	2.27	940	22.4	77.7	0.76	2.2	2.5	6.0	42	
Y2-132S-6	3	4	13.0	7.52	3.29	12.4	7.15	3.15	11.9	6.89	3.02	960	29.8	79.7	0.76	2.0	2.3	6.5	60	
Y2-132M1-6	4	5.5	16.9	9.82	4.30	16.2	9.33	4.11	15.5	9.00	3.94	960	39.8	81.4	0.76	2.0	2.3	6.5	70	
Y2-132M2-6	5.5	7.5	22.5	13.0	5.79	21.5	12.4	5.54	20.6	11.9	5.31	960	54.7	83.1	0.77	2.0	2.3	6.5	80	
Y2-160M-6	7.5	10	30.1	17.4	7.75	28.8	16.6	7.41	27.6	16.0	7.10	970	73.8	84.7	0.77	2.3	2.6	6.5	114	
Y2-160L-6	11	15	42.8	24.8	11.1	40.9	23.5	10.6	39.2	22.7	10.2	970	108.3	86.4	0.78	2.3	2.6	6.5	121	
Y2-180L-6	15	20	55.4	32.0	14.9	53.0	30.4	14.3	50.8	29.3	13.7	970	147.7	87.7	0.81	2.0	2.5	7.0	162	
Y2-200L1-6	18.5	25	67.6	39.1	18.2	64.7	37.2	17.4	62.0	35.8	16.7	970	182.1	88.6	0.81	2.1	2.8	6.5	209	
Y2-200L2-6	22	30	77.9	45.1	21.5	74.5	42.8	20.6	71.4	41.3	19.7	970	216.6	89.2	0.83	2.1	2.8	6.5	226	
Y2-225M-6	30	40	103	60.1	29.0	99.3	57.1	27.8	95.2	55.0	26.6	980	292.3	90.2	0.84	2.0	2.1	7.0	273	
Y2-250M-6	37	50	124	71.9	35.6	118	68.3	34.1	113	65.9	32.6	980	360.6	90.8	0.86	2.0	2.1	7.0	360	
Y2-280S-6	45	60	150	86.9	43.0	143	82.6	41.2	137	79.6	39.4	980	438.5	91.4	0.86	2.0	2.2	7.0	494	
Y2-280M-6	55	75	182	105	52.3	174	100	50.0	167	96.8	47.9	980	536.0	91.9	0.86	2.0	2.2	7.0	517	
Y2-315S-6	75	100	247	143	70.8	236	135	67.7	226	131	64.9	990	723.5	92.6	0.86	2.0	2.0	7.0	770	
Y2-315M-6	90	125	295	171	84.7	282	162	81.0	270	156	77.6	990	868.2	92.9	0.86	2.0	2.0	7.0	840	
Y2-315L1-6	110	150	359	208	103	344	197	98.6	329	190	94.5	990	1061.1	93.3	0.86	2.0	2.0	6.7	990	
Y2-315L2-6	132	180	425	246	123	407	234	118	390	225	113	990	1273.3	93.5	0.87	2.0	2.0	6.7	1040	
Y2-355M1-6	160	220	508	294	149	486	279	142	466	269	136	990	1543.4	93.8	0.88	1.9	2.0	6.7	1470	
Y2-355M2-6	200	270	634	367	186	606	348	178	581	336	170	990	1929.3	94.0	0.88	1.9	2.0	6.7	1640	
Y2-355L-6	250	340	793	459	232	758	436	222	727	420	213	990	2411.6	94.0	0.88	1.9	2.0	6.7	1740	

# Y2/Y2HE系列铸铁壳三相异步电动机

## Y2/Y2HE SERIES CAST IRON THREE PHASE INDUCTION MOTOR



技术参数 TECHNICAL DATA

IE1

型号 Model	额定功率 Rated Power		额定电流 Rated Current (A)										额定 转速 Speed rpm	额定 转矩 Tn N.m	效率 Eff. η(%)	功率 因数 P.F. cosφ	堵转转矩 额定转矩 Tst/Tn	最大转矩 额定转矩 Tmax/Tn	堵转电流 额定电流 Ist/In	重量 N.G kg
	kW	HP	220V	380V	660V	230V	400V	690V	240V	415V	720V									
Y2-801-8	0.18	0.25	1.52	0.88	0.31	1.45	0.84	0.30	1.39	0.80	0.28	680	2.53	51.0	0.61	1.8	2.0	3.3	17	
Y2-802-8	0.25	0.3	1.99	1.15	0.40	1.91	1.10	0.39	1.83	1.06	0.37	680	3.51	54.0	0.61	1.8	2.0	3.3	19	
Y2-90S-8	0.37	0.5	2.57	1.49	0.52	2.46	1.41	0.50	2.35	1.36	0.48	680	5.20	62.0	0.61	1.9	2.0	4.0	23	
Y2-90L-8	0.55	0.75	3.76	2.17	0.76	3.59	2.07	0.73	3.44	1.99	0.70	700	7.50	63.0	0.61	1.9	2.1	4.0	25	
Y2-100L1-8	0.75	1	4.14	2.40	0.92	3.96	2.28	0.88	3.79	2.19	0.85	700	10.2	71.0	0.67	1.9	2.1	4.0	33	
Y2-100L2-8	1.1	1.5	5.73	3.32	1.32	5.48	3.15	1.26	5.25	3.04	1.21	700	15.0	73.0	0.69	1.9	2.1	5.0	38	
Y2-112M-8	1.5	2	7.61	4.40	1.75	7.28	4.18	1.67	6.97	4.03	1.60	700	20.5	75.0	0.69	1.9	2.1	5.0	50	
Y2-132S-8	2.2	3	10.4	6.04	2.47	9.97	5.73	2.36	9.56	5.53	2.26	710	29.6	78.0	0.71	2.0	2.1	6.0	60	
Y2-132M-8	3	4	13.6	7.90	3.32	13.0	7.51	3.18	12.5	7.24	3.05	710	40.4	79.0	0.73	2.0	2.1	6.0	76	
Y2-160M1-8	4	5.5	17.7	10.2	4.32	16.9	9.76	4.13	16.2	9.41	3.96	720	53.1	81.0	0.73	2.0	2.1	6.0	112	
Y2-160M2-8	5.5	7.5	23.5	13.6	5.80	22.4	12.9	5.54	21.5	12.4	5.31	720	73.0	83.0	0.74	2.0	2.1	6.0	113	
Y2-160L-8	7.5	10	30.6	17.7	7.67	29.3	16.8	7.34	28.1	16.2	7.03	720	99.5	85.5	0.75	2.0	2.1	6.0	140	
Y2-180L-8	11	15	43.4	25.1	11.0	41.5	23.8	10.5	39.7	23.0	10.0	730	143.9	87.5	0.76	2.1	2.1	6.5	166	
Y2-200L-8	15	20	58.8	34.0	14.9	56.3	32.3	14.2	53.9	31.2	13.6	730	196.2	88.0	0.76	2.0	2.1	6.5	214	
Y2-225S-8	18.5	25	70.9	41.0	17.9	67.8	39.0	17.2	65.0	37.6	16.4	740	238.8	90.0	0.76	2.0	2.1	6.6	255	
Y2-225M-8	22	30	81.7	47.3	21.2	78.2	44.9	20.3	74.9	43.3	19.4	740	283.9	90.5	0.78	2.0	2.1	6.6	284	
Y2-250M-8	30	40	109	63.4	28.8	104	60.2	27.5	100	58.0	26.4	740	387.2	91.0	0.79	2.0	2.1	6.6	380	
Y2-280S-8	37	50	134	77.7	35.3	128	73.8	33.8	123	71.2	32.4	740	477.5	91.5	0.79	1.9	2.1	6.6	496	
Y2-280M-8	45	60	162	94.0	42.7	155	89.3	40.9	148	86.1	39.2	740	580.7	92.0	0.79	1.9	2.0	6.6	520	
Y2-315S-8	55	75	192	111	51.8	183	105	49.5	176	101	47.5	740	709.8	92.8	0.81	1.9	2.0	6.6	900	
Y2-315M-8	75	100	261	151	70.5	249	143	67.4	239	138	64.6	740	967.9	93.0	0.81	1.9	2.0	6.6	1000	
Y2-315L1-8	90	125	307	177	83.9	293	168	80.2	281	162	76.9	740	1161.5	93.8	0.82	1.8	2.0	6.6	1060	
Y2-315L2-8	110	150	374	216	102	358	205	97.9	343	198	93.8	740	1419.6	94.0	0.82	1.8	2.0	6.4	1130	
Y2-355M1-8	132	180	450	261	123	431	247	117	413	239	112	740	1703.5	93.7	0.82	1.8	2.0	6.4	1500	
Y2-355M2-8	160	220	543	314	148	519	298	142	498	288	136	740	2064.9	94.2	0.82	1.8	2.0	6.4	1600	
Y2-355L-8	200	270	669	387	185	640	368	177	613	354	169	740	2581.1	94.5	0.83	1.8	2.0	6.4	1700	
Y2-315S-10	45	60	172	99.6	43.0	164	94.6	41.1	157	91.2	39.4	590	728.4	91.5	0.75	1.5	2.0	6.2		
Y2-315M-10	55	75	209	121	52.3	200	115	50.0	191	110	47.9	590	890.3	92.0	0.75	1.5	2.0	6.2		
Y2-315L1-10	75	100	279	162	70.9	267	153	67.8	256	148	65.0	590	1214.0	92.5	0.76	1.5	2.0	6.2		
Y2-315L2-10	90	125	329	190	84.6	315	181	80.9	302	174	77.6	590	1456.8	93.0	0.77	1.5	2.0	6.2		
Y2-355M1-10	110	150	397	229	103	379	218	98.7	364	210	94.6	590	1780.5	93.2	0.78	1.3	2.0	6.0		
Y2-355M2-10	132	180	474	274	123	454	261	118	435	251	113	590	2136.6	93.5	0.78	1.3	2.0	6.0		
Y2-355L-10	160	220	575	333	149	550	316	143	527	305	137	590	2589.8	93.5	0.78	1.3	2.0	6.0		

技术参数 TECHNICAL DATA

IE2

型号 Model	额定功率 Rated Power		额定电流 Rated Current (A)										额定 转速 Speed rpm	效率 Eff. η(%)			功率 因数 P.F. cosφ	额定 转矩 Tn N.m	堵转转矩 额定转矩 Tst/Tn	最大转矩 额定转矩 Tmax/Tn	堵转电流 额定电流 Ist/In	重量 N.G kg
	kW	HP	220V	380V	660V	230V	400V	690V	240V	415V	720V	100%		75%	50%							
Y2HE801-2	0.75	1	3.06	1.77	1.02	2.93	1.69	0.98	2.81	1.62	0.94	2875	77.4	77.2	74.7	0.83	2.49	2.5	3	5.3	14.8	
Y2HE802-2	1.1	1.5	4.37	2.53	1.46	4.18	2.40	1.39	4.01	2.32	1.34	2875	79.6	79.7	78.9	0.83	3.65	3.2	3.8	7.0	17	
Y2HE90S-2	1.5	2	5.76	3.34	1.92	5.51	3.17	1.84	5.28	3.06	1.76	2890	81.3	81.4	80.7	0.84	4.96	2.7	3.5	7.1	22.5	
Y2HE90L-2	2.2	3	8.16	4.73	2.72	7.81	4.49	2.60	7.48	4.33	2.49	2890	83.2	82.9	82.2	0.85	7.27	2.4	3	6.9	25	
Y2HE100L-2	3	4	10.7	6.19	3.57	10.2	5.88	3.41	9.81	5.67	3.27	2891	84.6	84.5	82.8	0.87	9.91	3.2	4	8.0	34.5	
Y2HE112M-2	4	5.5	13.9	8.05	4.63	13.3	7.65	4.43	12.7	7.37	4.25	2914	85.8	86.1	85.4	0.88	13.1	2.5	3	7.5	45	
Y2HE132S1-2	5.5	7.5	18.9	10.9	6.28	18.0	10.4	6.01	17.3	10.0	5.76	2937	87.0	86.7	84.8	0.88	17.9	2.7	3.5	7.5	72	
Y2HE132S2-2	7.5	10	25.1	14.5	8.37	24.0	13.8	8.00	23.0	13.3	7.67	2940	88.1	88.4	87.8	0.89	24.4	2.4	3.3	7.5	80	
Y2HE-160M1-2	11	15	36.3	21.0	12.1	34.7	20.0	11.6	33.3	19.2	11.1	2930	89.4	88.9	87.4	0.89	35.9	2.2	2.9	7.6	108	
Y2HE-160M2-2	15	20	49.0	28.4	16.3	46.9	26.9	15.6	44.9	26.0	15.0	2930	90.3	89.9	88.1	0.89	48.9	2.3	3	7.6	117	
Y2HE-160L-2	18.5	25	60.0	34.7	20.0	57.4	33.0	19.1	55.0	31.8	18.3	2937	90.9	90.6	89.1	0.89	60.2	2.3	3.1	7.4	135	
Y2HE-180M-2	22	30	71.1	41.1	23.7	68.0	39.1	22.7	65.1	37.7	21.7	2940	91.3	91.0	89.4	0.89	71.5	2.8	3.2	7.8	183	
Y2HE-200L1-2	30	40	96.2	55.7	32.1	92.0	52.9	30.7	88.1	51.0	29.4	2950	92.0	91.8	90.2	0.89	97.1	2.6	3	7.8	227	
Y2HE-200L2-2	37	50	117	68.3	39.3	112	64.9	37.6	108	62.5	36.0	2950	92.5	92.4	90.7	0.89	119.8	2.6	3	7.7	246	
Y2HE-225M-2	45	60	142	82.7	47.6	136	78.6	45.5	130	75.7	43.6	2960	92.9	92.8	91.3	0.89	145.2	2.4	2.6	7.5	297	
Y2HE-250M-2	55	75	174	100	58.0	166	95.7	55.5	159	92.2	53.2	2965	93.2	93.3	91.5	0.89	177.2	2.3	2.8	7.1	379	
Y2HE-280S-2	75	100	235	136	78.6	225	129	75.2	216	125	72.0	2970	93.8	93.8	91.9	0.89	241.2	2.5	2.8	7.4	519	
Y2HE-280M-2	90	125	282	163	94.0	269	155	89.9	258	149	86.2	2970	94.1	94.0	92.2	0.89	289.4	2.8	2.8	7.6	580	
Y2HE-315S-2	110	150	340	196	113	325	187	108	311	180	103	2975	94.3	94.2	92.4	0.9	353.1	2.4	2.8	6.9	948	
Y2HE-315M-2	132	180	406	235	135	389	223	129	373	215	124	2975	94.6	94.6	92.7	0.9	423.7	2.6	2.9	7.1	1009	
Y2HE-315L1-2	160	220	486	281	162	465	267	155	446	258	148	2975	94.8	94.9	93.1	0.91	513.6	2.5	2.9	7.1	1111	
Y2HE-315L2-2	200	250	607	351	202	580	333	193	556	321	185	2975	95.0	95.1	93.3	0.91	642.0	2.5	2.8	6.9	1142	
Y2HE-355M-2	250	340	758	439	253	725	417	242	695	402	231	2980	95.0	95.0	93.4	0.91	801.2	2.5	2.8	7.0	1908	
Y2HE-355L-2	315	430	956	553	318	914	525	304	876	506	292	2980	95.0	95.1	93.4	0.91	1009.5	2.5	2.9	7.0	2346	



# Y2/Y2HE系列铸铁壳三相异步电动机

## Y2/Y2HE SERIES CAST IRON THREE PHASE INDUCTION MOTOR



技术参数 TECHNICAL DATA

IE2

型号 Model	额定功率 Rated Power		额定电流 Rated Current (A)										额定 转速 Speed rpm	效率 Eff. η(%)			功率 因数 P.F.	额定 转矩 Tn N.m	堵转转矩 Tst/Tn	最大转矩 Tmax/Tn	堵转电流 Ist/In	重量 N.G kg
	KW	HP	220V	380V	660V	230V	400V	690V	240V	415V	720V	100%		75%	50%	cosφ						
Y2HE802-4	0.75	1	3.30	1.91	1.10	3.15	1.81	1.05	3.02	1.75	1.01	1400	79.6	79.3	78.4	0.75	5.12	2.4	2.9	5	18	
Y2HE90S-4	1.1	1.5	4.73	2.74	1.58	4.52	2.60	1.51	4.33	2.51	1.44	1400	81.4	81.1	77.6	0.75	7.30	3	3.5	6	22	
Y2HE90L-4	1.5	2	6.34	3.67	2.11	6.06	3.49	2.02	5.81	3.36	1.94	1445	82.8	82.5	77.5	0.75	9.91	3.2	3.8	6.8	26.5	
Y2HE100L1-4	2.2	3	8.46	4.90	2.82	8.09	4.65	2.70	7.75	4.48	2.58	1440	84.3	84.4	83.7	0.81	14.6	3	3.5	7	35	
Y2HE100L2-4	3	4	11.2	6.50	3.74	10.7	6.18	3.58	10.3	5.95	3.43	1440	85.5	85.3	83.9	0.82	19.9	2.6	3.3	7	41.5	
Y2HE112M-4	4	5.5	14.8	8.56	4.93	14.1	8.13	4.71	13.6	7.84	4.52	1445	86.6	86.9	86.9	0.82	26.4	3.5	4	7.5	49	
Y2HE132S-4	5.5	7.5	20.1	11.6	6.69	19.2	11.0	6.40	18.4	10.6	6.13	1455	87.7	87.4	86.9	0.82	36.1	2.2	2.8	6.4	77	
Y2HE132M-4	7.5	10	26.7	15.5	8.91	25.6	14.7	8.52	24.5	14.2	8.17	1455	88.7	88.5	88.3	0.83	49.2	2.4	3	7	87	
Y2HE-160M-4	11	15	37.8	21.9	12.6	36.2	20.8	12.1	34.7	20.0	11.6	1460	89.8	89.7	88.6	0.85	71.9	2.5	2.9	6.9	110	
Y2HE-160L-4	15	20	50.5	29.2	16.8	48.3	27.8	16.1	46.3	26.8	15.4	1460	90.6	90.7	89.7	0.86	98.1	2.5	3	7.5	132	
Y2HE-180M-4	18.5	25	61.9	35.8	20.6	59.2	34.0	19.7	56.7	32.8	18.9	1465	91.2	91.1	90.5	0.86	120.2	2.6	3.1	7.8	172	
Y2HE-180L-4	22	30	73.3	42.4	24.4	70.1	40.3	23.4	67.2	38.9	22.4	1465	91.6	91.7	90.9	0.86	142.9	2.6	3.1	7.5	180	
Y2HE-200L-4	30	40	99.2	57.4	33.1	94.9	54.6	31.6	90.9	52.6	30.3	1475	92.3	92.2	91.3	0.86	194.9	2.4	2.9	7.1	247	
Y2HE-225S-4	37	50	121	70.5	40.6	116	67.0	38.8	111	64.6	37.2	1480	92.7	92.8	91.7	0.86	238.8	2.5	2.7	7.5	297	
Y2HE-225M-4	45	60	147	85.4	49.2	141	81.1	47.0	135	78.2	45.1	1480	93.1	93.2	92.1	0.86	290.4	2.5	2.8	7.6	322	
Y2HE-250M-4	55	75	179	103	59.8	171	98.7	57.2	164	95.2	54.8	1485	93.5	93.4	92.4	0.86	354.9	2.6	2.7	7.3	413	
Y2HE-280S-4	75	100	237	137	79.3	227	130	75.9	218	126	72.7	1480	94.0	94.1	92.8	0.88	484.0	2.7	2.7	7.6	558	
Y2HE-280M-4	90	125	284	165	95.0	272	156	90.8	261	151	87.1	1485	94.2	94.2	93.1	0.88	580.7	2.7	2.7	7.5	632	
Y2HE-315S-4	110	150	347	201	115	332	190	110	318	184	106	1480	94.5	94.4	93.3	0.88	707.4	2.7	2.9	7.1	826	
Y2HE-315M-4	132	180	415	240	138	397	228	132	381	220	127	1480	94.7	94.8	93.7	0.88	88.9	2.7	2.9	7.3	1037	
Y2HE-315L1-4	160	220	497	287	165	475	273	158	455	263	151	1480	94.9	94.8	93.8	0.89	1029.0	3	3	7.4	1107	
Y2HE-315L2-4	200	250	620	359	206	593	341	197	568	328	189	1480	95.1	95.1	94.0	0.89	1286.0	3	3	7.6	1156	
Y2HE-355M-4	250	340	766	443	255	733	421	244	702	406	234	1490	95.1	95.1	94.0	0.90	1602.0	2.8	2.9	7.5	1734	
Y2HE-355L-4	315	430	965	559	321	923	531	307	885	512	295	1490	95.1	95.1	94.0	0.90	2019.0	2.6	2.8	7.4	1940	

技术参数 TECHNICAL DATA

IE2

型号 Model	额定功率 Rated Power		额定电流 Rated Current (A)										额定 转速 Speed rpm	效率 Eff. η(%)			功率 因数 P.F.	额定 转矩 Tn N.m	堵转转矩 Tst/Tn	最大转矩 Tmax/Tn	堵转电流 Ist/In	重量 N.G kg
	KW	HP	220V	380V	660V	230V	400V	690V	240V	415V	720V	100%		75%	50%	cosφ						
Y2HE90S-6	0.75	1	3.60	2.09	1.20	3.45	1.98	1.15	3.30	1.91	1.10	934	75.9	76.1	75.1	0.72	7.67	2.2	2.4	4.5	23	
Y2HE90L-6	1.1	1.5	5.06	2.93	1.69	4.84	2.78	1.61	4.64	2.68	1.55	945	78.1	77.9	77.8	0.73	11.1	2.4	2.6	4.5	25	
Y2HE100L-6	1.5	2	6.67	3.86	2.22	6.38	3.67	2.13	6.11	3.53	2.04	945	79.8	80.1	78.5	0.74	15.2	1.8	2.2	4.2	33	
Y2HE112M-6	2.2	3	9.54	5.52	3.18	9.12	5.25	3.04	8.74	5.06	2.91	960	81.8	81.9	81.5	0.74	21.9	2.3	2.8	4.5	51	
Y2HE132S-6	3	4	12.8	7.39	4.26	12.2	7.02	4.07	11.7	6.77	3.90	964	83.3	83.6	82.3	0.74	29.7	1.8	2.4	4.5	75	
Y2HE132M1-6	4	5.5	16.8	9.71	5.59	16.0	9.22	5.35	15.4	8.89	5.12	965	84.6	84.5	82.4	0.74	39.6	2.3	2.7	5	82	
Y2HE132M2-6	5.5	7.5	22.4	13.0	7.46	21.4	12.3	7.13	20.5	11.9	6.84	965	86.0	85.9	84.7	0.75	54.4	1.9	2.8	5.5	94	
Y2HE-160M-6	7.5	10.0	28.9	16.8	9.65	27.7	15.9	9.23	26.5	15.3	8.84	975	87.2	87	84.9	0.78	73.8	2	3	6.5	130	
Y2HE-160L-6	11	15.0	41.2	23.9	13.7	39.4	22.7	13.1	37.8	21.8	12.6	970	88.7	88.4	86.1	0.79	108.3	2.4	3.3	7.5	156	
Y2HE-180L-6	15	20.0	54.2	31.4	18.1	51.8	29.8	17.3	49.7	28.7	16.6	980	89.7	89.8	88.7	0.81	146.9	2	2.7	6.4	183	
Y2HE-200L1-6	18.5	25.0	66.3	38.4	22.1	63.4	36.5	21.1	60.8	35.1	20.3	980	90.4	90.4	89.5	0.81	180.3	2.3	3	7	220	
Y2HE-200L2-6	22	30.0	77.5	44.8	25.8	74.1	42.6	24.7	71.0	41.1	23.7	980	90.9	90.9	89.9	0.82	214.4	2.3	2.8	7	240	
Y2HE-225M-6	30	40.0	106	61.4	35.3	101	58.3	33.8	97.2	56.2	32.4	985	91.7	91.8	90.6	0.81	292.3	2.2	2.7	6.5	275	
Y2HE-250M-6	37	50.0	125	72.6	41.8	119	69.0	40.0	114	66.5	38.3	985	92.2	92.3	91.1	0.84	360.6	2.5	2.7	6.9	385	
Y2HE-280S-6	45	60.0	148	85.8	49.4	141	81.5	47.2	135	78.5	45.3	985	92.7	92.7	91.5	0.86	438.5	2.2	2.4	7	482	
Y2HE-280M-6	55	75.0	180	104	60.1	172	99.2	57.5	165	95.6	55.1	985	93.1	93.2	92.0	0.86	536.0	2.4	2.5	7.1	559	
Y2HE-315S-6	75	100	244	141	81.4	233	134	77.9	223	129	74.6	985	93.7	93.7	92.5	0.86	727.2	2.8	3	7.3	933	
Y2HE-315M-6	90	125	292	169	97.4	279	160	93.2	267	154	89.3	985	94.0	93.9	92.6	0.86	872.6	2.7	2.9	7.1	1013	
Y2HE-315L1-6	110	150	356	206	118	340	195	113	326	188	108	985	94.3	94.3	92.9	0.86	1066.0	2.9	2.9	7.4	1086	
Y2HE-315L2-6	132	180	425	246	141	407	234	135	390	225	130	985	94.6	94.7	93.1	0.86	1280.0	3	3.1	7.6	1208	
Y2HE-355M1-6	160	220	509	294	169	487	280	162	466	269	155	990	94.8	94.9	93.4	0.87	1543.0	3.1	3.1	7.6	1581	
Y2HE-355M2-6	200	250	635	367	211	607	349	202	582	336	194	990	95.0	95.1	93.8	0.87	1929.0	3	3	7.8	1632	
Y2HE-355L-6	250	340	793	459	264	759	436	253	727	420	242	990	95.0	95.0	93.9	0.87	2412.0	3.1	3	7.7	1734	

# YE3系列铸铁壳三相异步电动机

## YE3 SERIES CAST IRON THREE PHASE INDUCTION MOTOR

IE3-50HZ



### 产品简介

该系列电动机设计符合IEC国际标准，可广泛应用于众多对质量及可靠性要求极高的领域，如：工业、商业、建筑业、楼宇给水和农业灌溉等。

### 产品特点

- 功率范围：0.18-315kW
- 机座号：80-355
- 额定电压：可根据客户需求
- 额定频率：50/60Hz
- 能效等级：IE3（国标能效三级）
- 绝缘等级：F
- 防护等级：IP55
- 冷却方式：IC411
- 工作制：S1
- 安装方式：B3、B35、B5

### 产品优势

- 结构紧凑
- 外形美观
- 低噪音
- 起动转矩大
- 适用于高负载工作
- 高效节能
- 安装便捷，维护方便
- 可靠耐用

### PRODUCT INTRODUCTION

This series of motor design conforms to IEC standard. It could be widely applied in the field with high requirement on quality and reliability, such as manufacturing, commerce, construction, water supply and agricultural irrigation, etc.

### PRODUCT FEATURES

- Output: 0.18-315kW
- Frame size: 80-355
- Rated voltage: according to customer's requirements
- Rated frequency: 50/60Hz
- Efficiency: IE3 (GB-grade 3)
- Insulation class: F
- Protection grade: IP55
- Cooling method: IC411
- Duty type: S1
- Installation method: B3, B35, B5

### PRODUCT ADVANTAGE

- Compact structure design
- Attractive appearance
- Low noise
- High starting torque
- Suitable for heavy duty application
- High efficiency and energy saving
- Easy installation and maintenance
- Reliable and durable

**ABLE**<sup>®</sup>  
ABLE MOTOR  
[www.ablecn.com](http://www.ablecn.com)

IMB3

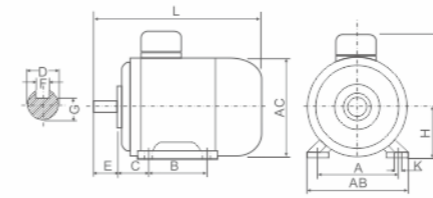

IMB35

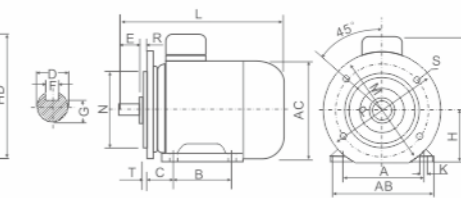

IMB5

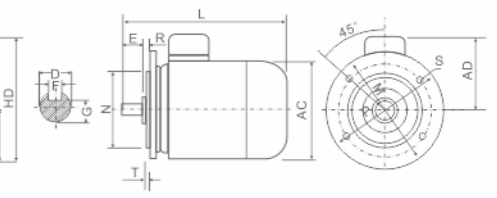

### 外形及安装尺寸 INSTALLATION AND OVERALL DIMENSIONS

机座号 Frame Size	安装尺寸 Mounting Dimensions (mm)																外形尺寸 Overall Dimensions (mm)								
	A	B	C	D		E		F		G		H	K	M	N	P	R	S	T	AB	AC	AD	HD	L	
				2P	4,6,8,10P	2P	4,6,8,10P	2P	4,6,8,10P	2P	4,6,8,10P													2P	4,6,8,10P
80M	125	100	50	19	40	6	15.5	80	10	165	130	200	0	12	3.5	165	168	142	222	298					
90S	140	100	56	24	50	8	20	90	10	165	130	200	0	12	3.5	176	181	150	240	350					
90L	140	125	56	24	50	8	20	90	10	165	130	200	0	12	3.5	176	181	150	240	380					
100L	160	140	63	28	60	8	24	100	12	215	180	250	0	14.5	4	200	206	181	281	428					
112M	190	140	70	28	60	8	24	112	12	215	180	250	0	14.5	4	226	220	188	300	395	465				
132S	216	140	89	38	80	10	33	132	12	265	230	300	0	14.5	4	262	259	208	340	463					
132M	216	178	89	38	80	10	33	132	12	265	230	300	0	14.5	4	262	259	208	340	501					
160M	254	210	108	42	110	12	37	160	14.5	300	250	350	0	4-18.5	5	314	314	264	424	610					
160L	254	254	108	42	110	12	37	160	14.5	300	250	350	0	4-18.5	5	314	314	264	424	654					
180M	279	241	121	48	110	14	42.5	180	14.5	300	250	350	0	4-18.5	5	349	354	283	463	686					
180L	279	279	121	48	110	14	42.5	180	14.5	300	250	350	0	4-18.5	5	349	354	283	463	724					
200L	318	305	133	55	110	16	49	200	18.5	350	300	400	0	4-18.5	5	388	396	312	512	769					
225S	356	286	149	-	60	-	140	-	18	-	53	225	18.5	400	350	450	0	8-18.5	5	431	445	333	558	-	823
225M	356	311	149	55	60	110	140	16	18	49	53	225	18.5	400	350	450	0	8-18.5	5	431	445	333	558	818	848
250M	406	349	168	60	65	140	180	18	18	53	58	250	24	500	450	550	0	8-18.5	5	484	484	367	617	909	
280S	457	368	190	65	75	140	180	18	20	58	67.5	280	24	500	450	550	0	8-18.5	5	542	546	396	676	959	979
280M	457	419	190	65	75	140	180	18	20	58	67.5	280	24	500	450	550	0	8-18.5	5	542	546	396	676	1010	1030
315S	508	406	216	65	80	140	170	18	22	58	71	315	28	600	550	660	0	8-24	6	628	620	540	855	1193	1223
315M	508	457	216	65	80	140	170	18	22	58	71	315	28	600	550	660	0	8-24	6	628	620	540	855	1303	1333
315L	508	508	216	65	80	140	170	18	22	58	71	315	28	600	550	660	0	8-24	6	628	620	540	855	1303	1333
355M	610	560	254	75	95	140	170	20	25	67.5	86	355	28	740	680	800	0	8-24	6	726	701	666	1021	1509	1539
355L	610	630	254	75	95	140	170	20	25	67.5	86	355	28	740	680	800	0	8-24	6	726	701	666	1021	1509	1539

技术参数 TECHNICAL DATA

IE3

型号 Model	功率 Rated Power		额定电流 Rated Current (A)										额定 转速 Speed	效率 Eff.	功率 因数 PF.	额定 转矩 Tn	堵转 转矩/ 额定 转矩	最大 转矩/ 额定 转矩	启动 电流/ 额定 电流	净重 N.G
	KW	HP	220V	380V	660V	230V	400V	690V	240V	415V	720V	rpm								
YE3-801-2	0.75	1	3.0	1.7	1.0	2.8	1.6	0.9	2.7	1.6	0.9	2900	80.7	0.82	2.49	2.5	3.0	7.3	20	
YE3-802-2	1.1	1.5	4.2	2.4	1.4	4.0	2.3	1.3	3.9	2.2	1.3	2910	82.7	0.83	3.65	2.8	3.5	8.7	21	
YE3-90S-2	1.5	2	5.6	3.2	1.9	5.3	3.1	1.8	5.1	3.0	1.7	2920	84.2	0.84	4.95	2.4	3.2	8.5	26	
YE3-90L-2	2.2	3	7.9	4.6	2.6	7.6	4.3	2.5	7.2	4.2	2.4	2915	85.9	0.85	7.26	2.6	3.5	8.5	29	
YE3-100L-2	3	4	10.4	6.0	3.5	9.9	5.7	3.3	9.5	5.5	3.2	2910	87.1	0.87	9.90	3.2	3.5	8.5	43	
YE3-112M-2	4	5.5	13.5	7.8	4.5	13.0	7.4	4.3	12.4	7.2	4.1	2920	88.1	0.88	13.1	2.6	3.0	8.6	51	
YE3-132S1-2	5.5	7.5	18.4	10.6	6.1	17.6	10.1	5.9	16.9	9.7	5.6	2920	89.2	0.88	17.9	2.5	2.8	8.6	76	
YE3-132S2-2	7.5	10	24.8	14.4	8.3	23.7	13.7	7.9	22.8	13.2	7.6	2925	90.1	0.88	24.4	2.5	3.0	8.5	84	
YE3-132M1-2	9.2	12.5	30.3	17.5	10.1	29.0	16.7	9.7	27.8	16.1	9.3	2930	90.6	0.88	30.0	2.6	3.2	8.8	95	
YE3-160M1-2	11	15	35.6	20.6	11.9	34.0	19.6	11.3	32.6	18.9	10.9	2940	91.2	0.89	35.7	2.7	3.6	8.8	122	
YE3-160M2-2	15	20	48.1	27.9	16.0	46.0	26.5	15.3	44.1	25.5	14.7	2935	91.9	0.89	48.8	2.6	3.6	9.0	137	
YE3-160L-2	18.5	25	59.0	34.2	19.7	56.5	32.5	18.8	54.1	31.3	18.0	2930	92.4	0.89	60.3	2.7	3.6	9.0	150	
YE3-180M-2	22	30	70.0	40.5	23.3	66.9	38.5	22.3	64.1	37.1	21.4	2945	92.7	0.89	71.3	2.7	3.2	8.8	198	
YE3-200L1-2	30	40	94.8	54.9	31.6	90.7	52.1	30.2	86.9	50.3	29.0	2950	93.3	0.89	97.1	2.0	2.7	8.2	244	
YE3-200L2-2	37	50	116	67.4	38.8	111	64.0	37.1	107	61.7	35.6	2950	93.7	0.89	120	2.7	3.0	8.4	261	
YE3-225M-2	45	60	141	81.7	47.1	135	77.6	45.0	129	74.8	43.1	2970	94.0	0.89	145	3.2	2.6	9.4	324	
YE3-250M-2	55	75	172	100	57.3	165	95	54.8	158	91.2	52.5	2965	94.3	0.89	177	2.5	3.2	7.8	407	
YE3-280S-2	75	100	234	135	77.8	223	128	74.5	214	124	71.4	2970	94.7	0.89	241	2.5	3.1	7.8	575	
YE3-280M-2	90	125	279	162	93.1	267	154	89.1	256	148	85.4	2970	95.0	0.89	289	2.6	3.0	7.5	600	
YE3-315S-2	110	150	337	195	112	322	185	107	309	179	103	2975	95.2	0.9	353	2.1	2.8	7.4	876	
YE3-315M-2	132	180	403	234	134	386	222	129	370	214	123	2975	95.4	0.9	424	2.0	2.7	7.0	974	
YE3-315L1-2	160	220	483	279	161	462	265	154	442	256	147	2975	95.6	0.91	514	1.9	2.7	6.4	1009	
YE3-315L2-2	200	270	602	349	201	576	331	192	552	319	184	2975	95.8	0.91	642	2.1	2.8	8.6	1132	
YE3-355M-2	250	340	753	436	251	720	414	240	690	399	230	2980	95.8	0.91	801	1.7	2.3	6.7	1643	
YE3-355L-2	315	430	948	549	316	907	522	302	869	503	290	2980	95.8	0.91	1009	1.7	2.3	6.6	1800	
YE3-802-4	0.75	1	3.2	1.8	1.1	3.0	1.7	1.0	2.9	1.7	1.0	1445	82.5	0.75	5.04	3.0	3.6	7.2	22	
YE3-90S-4	1.1	1.5	4.5	2.6	1.5	4.3	2.5	1.4	4.1	2.4	1.4	1445	84.1	0.76	7.27	2.5	3.0	8.0	27	
YE3-90L-4	1.5	2	6.0	3.5	2.0	5.7	3.3	1.9	5.5	3.2	1.8	1440	85.3	0.77	9.91	2.9	3.2	8.1	32	
YE3-100L1-4	2.2	3	8.2	4.8	2.7	7.9	4.5	2.6	7.5	4.4	2.5	1455	86.7	0.81	14.6	3.1	3.7	8.1	44	
YE3-100L2-4	3	4	10.9	6.3	3.6	10.5	6.0	3.5	10.0	5.8	3.3	1450	87.7	0.82	20.0	3.2	3.7	8.6	49	
YE3-112M-4	4	5.5	14.4	8.4	4.8	13.8	7.9	4.6	13.2	7.7	4.4	1455	88.6	0.82	26.5	3.0	3.7	8.8	56	
YE3-132S-4	5.5	7.5	19.4	11.2	6.5	18.6	10.7	6.2	17.8	10.3	5.9	1460	89.6	0.83	36.0	2.8	3.6	8.6	81	
YE3-132M-4	7.5	10	25.9	15.0	8.6	24.8	14.3	8.3	23.8	13.7	7.9	1460	90.4	0.84	49.1	3.2	3.6	8.6	91	
YE3-132M2-4	9.2	12.5	31.6	18.3	10.5	30.2	17.4	10.1	29.0	16.8	9.7	1460	90.9	0.84	60.2	3.2	3.6	8.6	101	
YE3-160M-4	11	15	37.2	21.5	12.4	35.5	20.4	11.8	34.1	19.7	11.4	1460	91.4	0.85	72.0	3.5	3.8	8.8	122	
YE3-160L-4	15	20	49.7	28.8	16.6	47.5	27.3	15.8	45.6	26.3	15.2	1460	92.1	0.86	98.1	3.5	3.8	8.8	144	
YE3-180M-4	18.5	25	61.0	35.3	20.3	58.3	33.5	19.4	55.9	32.3	18.6	1465	92.6	0.86	121	2.5	3.4	7.8	182	
YE3-180L-4	22	30	72.2	41.8	24.1	69.0	39.7	23.0	66.2	38.3	22.1	1465	93.0	0.86	143	2.6	2.7	8.0	209	
YE3-200L-4	30	40	97.8	56.6	32.6	93.6	53.8	31.2	89.7	51.8	29.9	1475	93.6	0.86	194	3.0	3.7	8.6	280	
YE3-225S-4	37	50	120	69.6	40.1	115	66.1	38.3	110	63.7	36.7	1480	93.9	0.86	239	3.4	3.3	9.4	308	
YE3-225M-4	45	60	146	84.4	48.6	139	80.2	46.5	134	77.3	44.5	1480	94.2	0.86	290	3.2	3.5	9.0	343	
YE3-250M-4	55	75	177	103	59.1	170	97.6	56.6	163	94.1	54.2	1485	94.6	0.86	354	3.0	3.1	8.5	456	
YE3-280S-4	75	100	235	136	78.5	225	129	75.1	216	125	71.9	1480	95.0	0.88	484	2.7	2.8	8.0	565	
YE3-280M-4	90	125	282	163	94.0	270	155	89.9	258	149	86.1	1485	95.2	0.88	579	2.7	2.8	8.0	657	
YE3-315S-4	110	150	344	199	115	329	189	110	315	182	105	1480	95.4	0.88	710	2.6	2.7	8.2	876	
YE3-315M-4	132	180	412	238	137	394	226	131	377	218	126	1480	95.6	0.88	852	2.5	2.8	8.1	994	
YE3-315L1-4	160	220	492	285	164	471	271	157	451	261	150	1480	95.8	0.89	1032	2.3	2.7	7.8	1078	
YE3-315L2-4	200	270	614	356	205	588	338	196	563	326	188	1480	96.0	0.89	1291	2.1	2.5	7.3	1238	
YE3-355M-4	250	340	759	440	253	726	418	242	696	403	232	1490	96.0	0.9	1602	2.1	2.5	7.3	1719	
YE3-355L-4	315	430	957	554	319	915	526	305	877	507	292	1490	96.0	0.9	2019	2.3	2.5	7.5	1823	

技术参数 TECHNICAL DATA

IE3

型号 Model	功率 Rated Power		额定电流 Rated Current (A)										额定 转速 Speed	效率 Eff.	功率 因数 PF.	额定 转矩 Tn	堵转 转矩/ 额定 转矩	最大 转矩/ 额定 转矩	启动 电流/ 额定 电流	净重 N.G
	KW	HP	220V	380V	660V	230V	400V	690V	240V	415V	720V	rpm								
YE3-90S-6	0.75	1	3.51	2.03	1.17	3.36	1.93	1.12	3.22	1.86	1.07	955	78.9	0.71	7.66	1.9	2.3	6.0	27	
YE3-90L-6	1.1	1.5	4.88	2.83	1.63	4.67	2.69	1.56	4.48	2.59	1.49	955	81.0	0.73	11.1	2.6	3.0	6.0	29	
YE3-100L-6	1.5	2	6.54	3.78	2.18	6.25	3.59	2.08	5.99	3.47	2.00	960	82.5	0.73	15.1	2.6	3.1	6.5	42	
YE3-112M-6	2.2	3	9.26	5.36	3.09	8.85	5.09	2.95	8.48	4.91	2.83	965	84.3	0.74	22.0	2.2	3.0	6.6	53	
YE3-132S-6	3	4	12.4	7.20	4.14	11.9	6.84	3.96	11.4	6.59	3.80	968	85.6	0.74	29.6	2.7	3.8	7.8	79	
YE3-132M1-6	4	5.5	16.3	9.46	5.45	15.6	8.99	5.21	15.0	8.66	4.99	968	86.8	0.74	39.5	2.3	2.7	7.8	86	
YE3-132M2-6	5.5	7.5	21.9	12.7	7.29	20.9	12.0	6.97	20.0	11.6	6.68	968	88.0	0.75	54.3	2.3	2.7	8.1	98	
YE3-160M-6	7.5	10	28.3	16.4	9.44	27.1	15.6	9.03	26.0	15.0	8.65	975	89.1	0.78	73.5	2.4	3.1	7.8	120	
YE3-160L-6	11	15	40.5	23.4	13.5	38.7	22.3	12.9	37.1	21.5	12.4	970	90.3	0.79	108	2.2	2.4	7.8	140	
YE3-180L-6	15	20	53.3	30.9	17.8	51.0	29.3	17.0	48.8	28.2	16.3	980	91.2	0.81	146	2.2	2.6	6.0	186	
YE3-200L1-6	18.5	25	65.4	37.8	21.8	62.5	35.9	20.8	59.9	34.7	20.0	980	91.7	0.81	180	2.2	2.5	6.5	235	
YE3-200L2-6	22	30	76.4	44.2	25.5	73.0	42.0	24.3	70.0	40.5	23.3	980	92.2	0.82	214	2.4	2.8	7.0	253	
YE3-225M-6	30	40	105	60.6	34.9	100	57.5	33.4	95.9	55.5	32.0	985	92.9	0.81	291	2.0	2.3	6.5	295	
YE3-250M-6	37	50	124	71.7	41.3	119	68.1	39.5	114	65.7	37.9	985	93.3	0.84	359	2.1	2.3	6.8	398	
YE3-280S-																				

# YE3韩国市场铸铁壳三相异步电动机

## YE3 SERIES CAST IRON THREE PHASE INDUCTION MOTOR FOR SOUTH KOREAN MARKET

IE3-60HZ



### 产品简介

该系列电动机是专门为韩国市场设计三相异步电动机，拥有KC产品安全认证，适用于水泵、风机、空压机、减速机、真空泵等产品的配套使用，可广泛应用于工业、商业、建筑业、楼宇给水和农业灌溉等众多领域。

### 产品特点

- 功率范围：11-315kW
- 机座号：160-355
- 能效等级：IE3
- 电压：支持多种电压
- 频率：60Hz
- 冷却方式：IC411
- 防护等级：IP55
- 绝缘等级：F
- 环境温度：-15~40℃
- 海拔高度：不超过1000m

### 产品优势

- 结构紧凑
- 外形美观
- 低噪音
- 起动转矩大
- 高效节能
- 安装便捷，维护方便
- 可靠耐用

### PRODUCT INTRODUCTION

This series of motor is especially designed for South Korean Market. It has "KC" Korea certification. It could be applied as a drive of pump, blower, air compressor, gear reducer, and vacuum pump, etc. that can be widely used in the variety of fields, such as industry, commerce, construction, water supply and agricultural irrigation, etc.

### PRODUCT FEATURES

- Output: 11-315kW
- Frame size: 160-355
- Efficiency: IE3
- Voltage: multi-voltage available
- Frequency: 60Hz
- Cooling method: IC411
- Protection grade: IP55
- Insulation class: F
- Ambient temperature: -15~40℃
- Altitude: not exceeding 1000m

### PRODUCT ADVANTAGE

- Compact structure design
- Attractive appearance
- Low noise
- High starting torque
- High efficiency and energy saving
- Easy installation and maintenance
- Reliable and durable



www.ablecn.com

IMB3

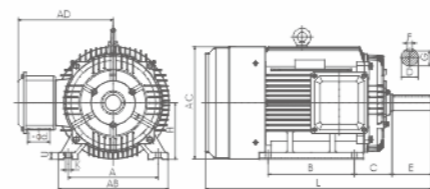

IMB35

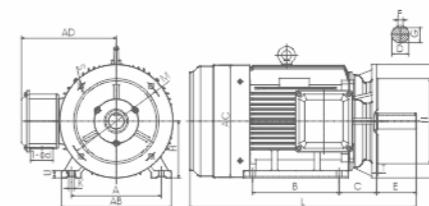

IMB5

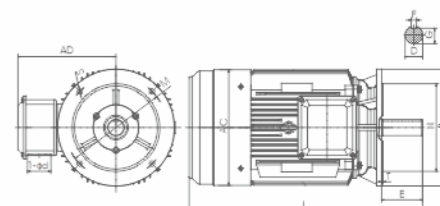

IE3-60Hz 韩国市场外形及安装尺寸 INSTALLATION AND OVERALL DIMENSIONS

机座号 Frame Size	输出功率 Output (kW)		安装尺寸 Mounting Dimensions (mm)														外形尺寸 Overall Dimensions (mm)					
	2P	4P	A	B	C	D	E	F	G	H	K	U	N	T	M	P	S	d	AB	AC	AD	L
160M	11/15	11	254	210	108	42k6	110	12	37	160	4-φ14.5	20	250	5	300	350	4-φ18.5	45	314	314	287	610
160L	18.5	15	254	254	108	42k6	110	12	37	160	4-φ14.5	20	250	5	300	350	4-φ18.5	45	314	314	287	654
180M	22	18.5	279	241	121	48k6	110	14	42.5	180	4-φ14.5	22	250	5	300	350	4-φ18.5	45	349	354	306	686
180L		22	279	279	121	48k6	110	14	42.5	180	4-φ14.5	22	250	5	300	350	4-φ18.5	45	349	354	306	724
180L	--	30	279	279	121	55m6	110	14	42.5	180	4-φ14.5	22	250	5	300	350	4-φ18.5	45	349	354	306	724
200L	30/37/45	-	318	305	133	55m6	110	16	49	200	4-φ18.5	25	300	5	350	400	4-φ18.5	80	388	396	335	769
200L	--	30/37/45	318	305	133	60m6	140	18	53	200	4-φ18.5	25	300	5	350	400	4-φ18.5	80	388	396	335	799
225S	--	37	356	286	149	65m6	140	18	58	225	6-φ18.5	28	350	5	400	450	8-φ18.5	80	431	445	356	823
225M	45/55	-	356	286/311	149	55m6	110	16	49	225	6-φ18.5	28	350	5	400	450	8-φ18.5	80	431	445	356	818
225M	--	45/55	356	286/311	149	65m6	140	18	58	225	6-φ18.5	28	350	5	400	450	8-φ18.5	80	431	445	356	848
250M	55/75/90	-	406	311/349	168	55m6	110	16	49	250	6-φ24	30	450	5	500	550	8-φ18.5	80	484	484	381	879
250M	--	55/75/90	406	311/349	168	75m6	140	20	67.5	250	6-φ24	30	450	5	500	550	8-φ18.5	80	484	484	381	909
280S	75	-	457	368	190	55m6	110	16	49	280	6-φ24	35	450	5	500	550	8-φ18.5	80	542	546	408	949
280S	--	75	457	368	190	85m6	170	22	76	280	6-φ24	35	450	5	500	550	8-φ18.5	80	542	546	408	1009
280M	90/110/132	-	457	368/419	190	75m6	110	16	49	280	6-φ24	35	450	5	500	550	8-φ18.5	80	542	546	408	1000
280M	--	90/110/132	457	368/419	190	95m6	170	22	76	280	6-φ24	35	450	5	500	550	8-φ18.5	80	542	546	408	1060
315S	110	-	508	406	216	75m6	140	20	67.5	315	6-φ28	45	550	6	600	660	8-φ24	80	628	620	521	1193
315S	--	110	508	406	216	95m6	170	25	86	315	6-φ28	45	550	6	600	660	8-φ24	80	628	620	521	1223
315M	132	-	508	457/508	216	75m6	140	20	67.5	315	6-φ28	45	550	6	600	660	8-φ24	80	628	620	521	1303
315M	--	132	508	457/508	216	95m6	170	25	86	315	6-φ28	45	550	6	600	660	8-φ24	80	628	620	521	1333
315L	160/200	-	508	457/508	216	75m6	140	20	67.5	315	6-φ28	45	550	6	600	660	8-φ24	80	628	620	521	1303
315L	--	160/220	508	457/508	216	95m6	170	25	86	315	6-φ28	45	550	6	600	660	8-φ24	80	628	620	521	1333
355ML	250/315	-	610	560/630	254	75m6	140	20	67.5	355	6-φ28	52	680	6	740	800	8-φ24	-	726	701	-	1509
355ML	--	250/315	610	560/630	254	95m6	170	25	86	355	6-φ28	52	680	6	740	800	8-φ24	-	726	701	-	1539

# YE3韩国市场铸铁壳三相异步电动机

## YE3 SERIES CAST IRON THREE PHASE INDUCTION MOTOR FOR SOUTH KOREAN MARKET



### 技术参数 TECHNICAL DATA

IE3

型号 Model	额定功率 Rated Power		额定电流 Rated Current (A)			额定 转速 Speed r/min	效率 Eff. η(%)	功率 因数 PF cosφ	额定 转矩 Tn N.m	堵转转矩 额定转矩 Tst/Tn	最大转矩 额定转矩 Tmax/Tn	启动电流 额定电流 Ist/In	重量 N.G kg
	KW	HP	220V	380V	660V								
YE3-160M1-2	11	15	35.5	20.6	11.8	3528	91.3	0.89	29.8	2.4	4.1	9.1	122
YE3-160M2-2	15	20	48.3	28.0	16.1	3522	91.5	0.89	40.7	2.3	3.8	8.6	137
YE3-160L-2	18.5	25	59.2	34.3	19.7	3516	92.1	0.89	50.2	2.3	3.7	8.7	150
YE3-180M-2	22	30	70.4	40.7	23.5	3534	92.2	0.89	59.5	3.3	3.8	8.8	198
YE3-180L-2	30	40	95.7	55.4	31.9	3540	92.4	0.89	80.9	2.0	2.3	7.6	218
YE3-200L1-2	30	40	95.4	55.2	31.8	3540	92.7	0.89	80.9	2.6	3.5	8.5	244
YE3-200L2-2	37	50	117	67.6	38.9	3540	93.4	0.89	99.8	2.8	3.5	8.9	261
YE3-200L3-2	45	60	142	82.1	47.3	3564	93.6	0.89	121	3.2	3.6	9.5	272
YE3-225M-2	45	60	142	82.1	47.3	3564	93.6	0.89	121	2.7	3.6	9.1	324
YE3-225M2-2	55	75	173	100	57.8	3558	93.6	0.89	148	2.0	2.3	7.7	324
YE3-250M-2	55	75	173	100	57.8	3558	93.6	0.89	148	2.5	3.7	8.8	407
YE3-250M2-2	75	100	235	136	78.3	3564	94.1	0.89	201	2.8	3.2	9.0	435
YE3-250M3-2	90	125	279	162	93.1	3564	95.0	0.89	241	3.2	3.6	9.5	448
YE3-280S-2	75	100	235	136	78.3	3564	94.2	0.89	201	2.4	2.7	7.4	575
YE3-280M-2	90	125	279	162	93.1	3564	95.0	0.89	241	2.4	2.7	7.1	600
YE3-280M2-2	110	150	338	195	113	3570	95.0	0.90	294	2.6	3.2	7.9	600
YE3-280M3-2	132	180	403	234	134	3570	95.4	0.90	353	2.8	3.3	8.1	608
YE3-315S-2	110	150	337	195	112	3570	95.2	0.90	294	2.1	2.5	7.1	876
YE3-315M-2	132	180	403	234	134	3570	95.4	0.90	353	2.0	2.5	7.1	974
YE3-315L1-2	160	220	484	280	161	3570	95.4	0.91	428	1.9	2.5	7.2	1009
YE3-315L2-2	200	250	602	349	201	3570	95.8	0.91	535	2.0	2.6	7.2	1132
YE3-355M-2	250	340	753	436	251	3576	95.8	0.91	668	1.7	2.3	7.2	1643
YE3-355L-2	315	430	948	549	316	3576	95.8	0.91	841	1.7	2.3	7.2	1800

### 技术参数 TECHNICAL DATA

IE3

型号 Model	额定功率 Rated Power		额定电流 Rated Current (A)			额定 转速 Speed r/min	效率 Eff. η(%)	功率 因数 PF cosφ	额定 转矩 Tn N.m	堵转转矩 额定转矩 Tst/Tn	最大转矩 额定转矩 Tmax/Tn	启动电流 额定电流 Ist/In	重量 N.G kg
	KW	HP	220V	380V	660V								
YE3-160M-4	11	15	36.8	21.3	12.3	1752	92.4	0.85	60.0	2.4	2.6	7.6	124
YE3-160L-4	15	20	49.2	28.5	16.4	1752	93.0	0.86	81.8	3.1	3.1	9.2	145
YE3-180M-4	18.5	25	60.3	34.9	20.1	1758	93.6	0.86	100	3.0	3.7	9.6	182
YE3-180L-4	22	30	71.5	41.4	23.8	1758	93.9	0.86	120	2.9	3.6	9.0	209
YE3-180L2-4	30	40	97.3	56.3	32.4	1770	94.1	0.86	162	3.3	3.8	9.6	209
YE3-200L-4	30	40	97.3	56.3	32.4	1770	94.1	0.86	162	2.6	3.0	9.6	280
YE3-200L2-4	37	50	119	69.2	39.8	1776	94.5	0.86	199	2.8	3.2	8.4	289
YE3-200L3-4	45	60	145	83.7	48.2	1776	95.0	0.86	242	2.9	3.3	8.7	289
YE3-225S-4	37	50	119	69.2	39.8	1776	94.5	0.86	199	3.5	3.3	9.7	308
YE3-225M-4	45	60	145	83.7	48.2	1776	95.0	0.86	242	3.6	3.2	9.6	308
YE3-225M2-4	55	75	176	102	58.6	1782	95.4	0.86	295	3.4	3.6	9.4	382
YE3-250M-4	55	75	176	102	58.6	1782	95.4	0.86	295	3.4	3.6	9.0	456
YE3-250M2-4	75	100	234	136	78.2	1776	95.4	0.88	403	3.4	3.8	9.7	492
YE3-250M3-4	90	125	281	163	93.8	1782	95.4	0.88	482	3.3	3.7	9.7	500
YE3-280S-4	75	100	234	135	78.0	1776	95.6	0.88	403	2.8	3.2	9.0	565
YE3-280M-4	90	125	281	163	93.7	1782	95.5	0.88	482	2.4	2.8	8.0	657
YE3-280M2-4	110	150	342	198	114	1776	95.8	0.88	591	3.2	3.6	9.6	701
YE3-280M3-4	132	180	411	238	137	1776	95.8	0.88	710	2.8	3.3	8.4	725
YE3-315S-4	110	150	342	198	114	1776	95.9	0.88	591	2.3	2.7	8.2	876
YE3-315M-4	132	180	409	237	136	1776	96.2	0.88	710	2.3	2.8	8.1	994
YE3-315L1-4	160	220	490	284	163	1776	96.2	0.89	860	2.3	2.7	7.8	1088
YE3-315L2-4	200	250	612	355	204	1776	96.3	0.89	1075	2.1	2.5	7.3	1238
YE3-355M-4	250	340	758	439	253	1788	96.2	0.90	1335	2.0	2.3	6.4	1719
YE3-355L-4	315	430	954	552	318	1788	96.3	0.90	1682	2.3	2.5	7.5	1823

# YE4三相异步电动机

## YE4 SERIES OF THREE PHASE (CAST IRON) ASYNCHRONOUS MOTOR

IE4-50HZ

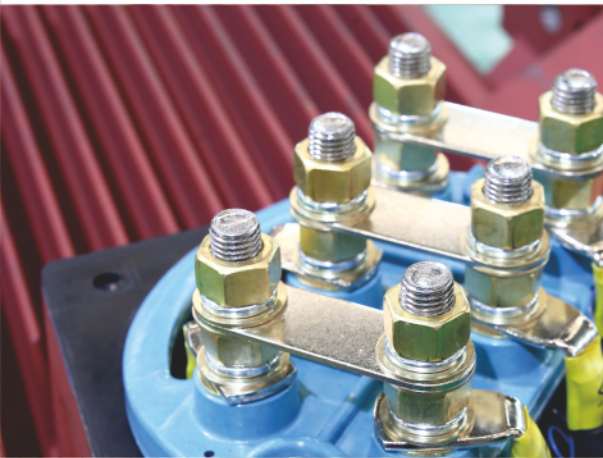

### 产品简介

该系列电动机设计符合IEC国际标准，可广泛应用于众多对质量及可靠性要求极高的领域，如：工业、商业、建筑业、楼宇给水和农业灌溉等。

### 产品特点

- 功率范围：0.75-315kW
- 机座号：80-355
- 能效等级：IE4（国标能效二级）
- 电压与频率：支持多种电压与频率
- 冷却方式：IC411，可选配IC416等；
- 注油装置：180-355机座标配可重复润滑轴承及油道
- 防护等级：IP55标配，可选配IP56等；
- 绝缘等级：F
- 环境温度：-15~40℃
- 海拔高度：不超过1000m

### 产品优势

- 结构紧凑
- 外形美观
- 低噪音
- 起动转矩大
- 高效节能
- 安装便捷，维护方便
- 可靠耐用

### PRODUCT INTRODUCTION

The motor design conforms to IEC standard. It could be widely applied in the field with high requirement on quality and reliability, such as manufacturing, commerce, construction, water supply and agricultural irrigation, etc.

### PRODUCT FEATURES

- Output: 0.75-315kW
- Frame size: 80-355
- Efficiency: IE4(GB-grade 2)
- Voltage & frequency: multi-voltage & frequency available
- Cooling method: IC411 (standard), IC416 (optional);
- Bearing: Maintenance-free bearing
- Protection grade: IP55 (standard.), IP56 (optional);
- Insulation class: F
- Ambient temperature: -15~40℃
- Altitude: not exceeding 1000m

### PRODUCT ADVANTAGE

- Compact structure design
- Attractive appearance
- Low noise
- High starting torque
- High efficiency and energy saving
- Easy installation and maintenance
- Reliable and durable

**ABLE**<sup>®</sup>  
ABLE MOTOR  
www.ablecn.com

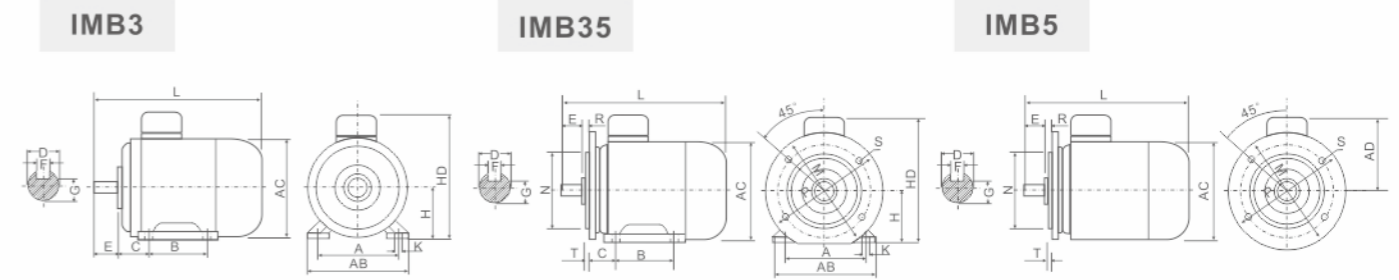

外形及安装尺寸 INSTALLATION AND OVERALL DIMENSIONS

机座号 Frame Size	安装尺寸 Mounting Dimensions (mm)																外形尺寸 Overall Dimensions(mm)									
	A	B	C	D		E		F		G		H	K	M	N	P	R	S	T	AB	AC	AD	HD	L		
				2P	4,6,8,10P	2P	4,6,8,10P	2P	4,6,8,10P	2P	4,6,8,10P													2P	4,6,8,10P	
80M	125	100	50	19	40	6	15.5	80	10	165	130	200	0	12	3.5	165	168	142	222	298						
80M-4	125	100	50	19	40	6	15.5	80	10	165	130	200	0	12	3.5	165	168	142	222	322						
90S	140	100	56	24	50	8	20	90	10	165	130	200	0	12	3.5	176	181	150	240	350						
90S-4	140	100	56	24	50	8	20	90	10	165	130	200	0	12	3.5	180	205	150	240	374						
90L	140	125	56	24	50	8	20	90	10	165	130	200	0	12	3.5	176	181	150	240	380	405					
100L	160	140	63	28	60	8	24	100	12	215	180	250	0	14.5	4	200	206	181	281	428						
112M-2	190	140	70	28	60	8	24	112	12	215	180	250	0	14.5	4	226	220	188	300	395	-					
112M-4/6	190	140	70	28	60	8	24	112	12	215	180	250	0	14.5	4	226	235	193	305	-	448.5					
132S-2	216	140	89	38	80	10	33	132	12	265	230	300	0	14.5	4	262	259	208	340	463	-					
132S	216	140	89	38	80	10	33	132	12	265	230	300	0	14.5	4	262	296	228	360	-	524					
132M-2	216	178	89	38	80	10	33	132	12	265	230	300	0	14.5	4	262	259	208	340	540	-					
132M	216	178	89	38	80	10	33	132	12	265	230	300	0	14.5	4	262	296	228	360	-	554					
160M	254	210	108	42	110	12	37	160	14.5	300	250	350	0	4-18.5	5	314	314	264	424	610						
160L	254	254	108	42	110	12	37	160	14.5	300	250	350	0	4-18.5	5	314	314	264	424	654						
180M	279	241	121	48	110	14	42.5	180	14.5	300	250	350	0	4-18.5	5	349	354	283	463	686						
180L	279	279	121	48	110	14	42.5	180	14.5	300	250	350	0	4-18.5	5	349	354	283	463	724						
200L	318	305	133	55	110	16	49	200	18.5	350	300	400	0	4-18.5	5	388	396	312	512	769						
225S	356	286	149	-	60	-	140	-	18	-	53	225	18.5	400	350	450	0	8-18.5	5	431	445	333	558	-	823	
225M	356	311	149	55	60	110	140	16	18	49	53	225	18.5	400	350	450	0	8-18.5	5	431	445	333	558	818	848	
250M	406	349	168	60	65	140	18	53	58	250	24	500	450	550	0	8-18.5	5	484	484	367	617	909				
280S	457	368	190	65	75	140	18	20	58	67.5	280	24	500	450	550	0	8-18.5	5	542	546	396	676	959	979		
280M	457	419	190	65	75	140	18	20	58	67.5	280	24	500	450	550	0	8-18.5	5	542	546	396	676	1010	1030		
315S	508	406	216	65	80	140	170	18	22	58	71	315	28	600	550	660	0	8-24	6	628	620	540	855	1193	1223	
315M	508	457	216	65	80	140	170	18	22	58	71	315	28	600	550	660	0	8-24	6	628	620	540	855	1303	1333	
315L	508	508	216	65	80	140	170	18	22	58	71	315	28	600	550	660	0	8-24	6	628	620	540	855	1303	1333	
355M	610	560	254	75	95	140	170	20	25	67.5	86	355	28	740	680	800	0	8-24	6	726	701	666	1021	1509	1539	
355L	610	630	254	75	95	140	170	20	25	67.5	86	355	28	740	680	800	0	8-24	6	726	701	666	1021	1509	1539	

技术参数 TECHNICAL DATA

IE4

型号 Model	额定功率 Rated Power		额定电流 Rated Current (A)								
	kW	HP	220V	380V	660V	230V	400V	690V	240V	415V	720V
YE4-801-2	0.75	1	2.84	1.64	0.95	2.72	1.56	0.91	2.60	1.51	0.87
YE4-802-2	1.1	1.5	4.08	2.36	1.36	3.90	2.25	1.30	3.74	2.16	1.25
YE4-90S-2	1.5	2	5.35	3.10	1.78	5.12	2.94	1.71	4.91	2.84	1.64
YE4-90L-2	2.2	3	7.63	4.42	2.54	7.30	4.20	2.43	6.99	4.04	2.33
YE4-100L-2	3	4	10.2	5.88	3.39	9.71	5.59	3.24	9.31	5.38	3.10
YE4-112M-2	4	5.5	13.3	7.67	4.42	12.7	7.29	4.23	12.1	7.03	4.05
YE4-132S1-2	5.5	7.5	18.0	10.4	6.01	17.3	9.92	5.75	16.5	9.57	5.51
YE4-132S2-2	7.5	10	24.1	14.0	8.04	23.1	13.3	7.69	22.1	12.8	7.37
YE4-160M1-2	11	15	35.0	20.3	11.7	33.5	19.3	11.2	32.1	18.6	10.7
YE4-160M2-2	15	20	47.4	27.4	15.8	45.3	26.1	15.1	43.5	25.1	14.5
YE4-160L-2	18.5	25	58.2	33.7	19.4	55.7	32.0	18.6	53.4	30.9	17.8
YE4-180M-2	22	30	69.0	40.0	23.0	66.0	38.0	22.0	63.3	36.6	21.1
YE4-200L1-2	30	40	93.6	54.2	31.2	89.5	51.5	29.8	85.8	49.6	28.6
YE4-200L2-2	37	50	115	66.6	38.4	110	63.3	36.7	105.5	61.0	35.2
YE4-225M-2	45	60	140	80.9	46.6	134	76.8	44.5	128.0	74.0	42.7
YE4-250M-2	55	75	170	98.5	56.7	163	93.6	54.3	156.0	90.2	52.0
YE4-280S-2	75	100	231	134	77.1	221	127	74	212	123	70.7
YE4-280M-2	90	125	277	160	92.3	265	152	88	254	147	84.6
YE4-315S-2	110	150	338	196	113	323	186	108	310	179	103
YE4-315M-2	132	180	405	234	135	387	223	129	371	214	124
YE4-315L1-2	160	220	490	284	163	469	269	156	449	260	150
YE4-315L2-2	200	270	611	354	204	585	336	195	560	324	187
YE4-355M-2	250	340	747	433	249	715	411	238	685	396	228
YE4-355L-2	315	430	941	545	314	900	518	300	863	499	288

YE4-802-4	0.75	1	3.10	1.80	1.03	2.97	1.71	0.99	2.84	1.65	0.95
YE4-90S-4	1.1	1.5	4.41	2.56	1.47	4.22	2.43	1.41	4.05	2.34	1.35
YE4-90L-4	1.5	2	5.87	3.40	1.96	5.62	3.23	1.87	5.38	3.11	1.79
YE4-100L1-4	2.2	3	8.17	4.73	2.72	7.81	4.49	2.60	7.49	4.33	2.50
YE4-100L2-4	3	4	10.9	6.30	3.63	10.4	5.99	3.47	10.0	5.77	3.33
YE4-112M-4	4	5.5	14.4	8.34	4.80	13.8	7.92	4.59	13.2	7.64	4.40
YE4-132S-4	5.5	7.5	19.6	11.4	6.54	18.8	10.8	6.26	18.0	10.4	6.00
YE4-132M-4	7.5	10	26.2	15.2	8.75	25.1	14.4	8.37	24.1	13.9	8.02
YE4-160M-4	11	15	37.3	21.6	12.4	35.7	20.5	11.9	34.2	19.8	11.4
YE4-160L-4	15	20	49.9	28.9	16.6	47.7	27.4	15.9	45.7	26.5	15.2
YE4-180M-4	18.5	25	60.6	35.1	20.2	58.0	33.3	19.3	55.6	32.1	18.5
YE4-180L-4	22	30	71.9	41.6	24.0	68.8	39.5	22.9	65.9	38.1	22.0
YE4-200L-4	30	40	97.6	56.5	32.5	93.4	53.7	31.1	89.5	51.7	29.8
YE4-225S-4	37	50	120	69.5	40.0	115	66.0	38.3	110.0	63.6	36.7
YE4-225M-4	45	60	146	84.3	48.5	139	80.1	46.4	133.5	77.2	44.5
YE4-250M-4	55	75	175	102	58.5	168	96.5	55.9	160.8	93.0	53.6
YE4-280S-4	75	100	236	136	78.6	225	130	75.1	216.0	125	72.0
YE4-280M-4	90	125	279	162	93.1	267	154	89.1	256	148	85.3
YE4-315S-4	110	150	337	195	112	322	185	107	309	179	103
YE4-315M-4	132	180	404	234	135	386	222	129	370	214	123
YE4-315L1-4	160	220	483	280	161	462	266	154	443	256	148
YE4-315L2-4	200	270	603	349	201	577	332	192	553	320	184
YE4-355M-4	250	340	754	436	251	721	415	240	691	400	230
YE4-355L-4	315	430	950	550	317	909	522	303	871	504	290

技术参数 TECHNICAL DATA

IE4

型号 Model	额定 转速 Speed	效率 Eff.	功率 因数 PF.	额定 转矩 Tn	堵转转矩 额定转矩 Tst/Tn	最大转矩 额定转矩 Tmax/Tn	堵转电流 额定电流 Ist/In	净重 N.G
	rpm	η(%)	cosφ	N.m				kg
YE4-801-2	2900	83.5	0.83	2.47	2.6	3.0	8.5	21.5
YE4-802-2	2900	85.2	0.83	3.62	2.6	3.2	8.5	22.5
YE4-90S-2	2910	86.5	0.85	4.92	2.6	3.2	9.5	28
YE4-90L-2	2910	88.0	0.86	7.22	2.6	3.2	9.5	31
YE4-100L-2	2910	89.1	0.87	9.85	2.7	3.3	9.5	46
YE4-112M-2	2920	90.0	0.88	13.1	2.6	3.3	9.5	57
YE4-132S1-2	2920	90.9	0.88	18.0	2.5	3.3	9.5	67
YE4-132S2-2	2925	91.7	0.89	24.5	2.5	3.3	9.5	79
YE4-160M1-2	2950	92.6	0.89	35.6	2.7	3.3	9.5	118
YE4-160M2-2	2950	93.3	0.89	48.6	2.6	3.3	9.5	133
YE4-160L-2	2950	93.7	0.89	59.9	2.7	3.3	9.5	153
YE4-180M-2	2960	94.0	0.89	71.0	2.7	3.2	9.5	194
YE4-200L1-2	2970	94.5	0.89	96.5	2.3	2.7	9.0	241
YE4-200L2-2	2970	94.8	0.89	119	2.7	3.0	9.0	262
YE4-225M-2	2970	95.0	0.89	145	2.6	3.2	9.0	326
YE4-250M-2	2970	95.3	0.89	177	2.5	3.2	9.0	440
YE4-280S-2	2975	95.6	0.89	241	2.5	3.1	8.5	621
YE4-280M-2	2975	95.8	0.89	289	2.6	3.0	8.5	585
YE4-315S-2	2975	96.0	0.89	353	2.1	2.8	8.5	845
YE4-315M-2	2975	96.2	0.89	424	2.2	2.7	8.5	953
YE4-315L1-2	2975	96.3	0.89	514	1.9	2.7	8.5	1022
YE4-315L2-2	2975	96.5	0.89	642	2.0	2.8	8.5	1133
YE4-355M-2	2980	96.5	0.91	801	1.7	2.3	8.5	1692
YE4-355L-2	2980	96.5	0.91	1009	1.7	2.3	8.5	1854

YE4-802-4	1445	85.7	0.74	4.96	2.8	3.2	8.0	22
YE4-90S-4	1445	87.2	0.75	7.27	2.6	3.2	8.5	27
YE4-90L-4	1450	88.2	0.76	9.88	2.6	3.2	9.0	32
YE4-100L1-4	1455	89.5	0.79	14.4	2.7	3.3	9.0	46
YE4-100L2-4	1455	90.4	0.80	19.7	2.7	3.3	9.0	48
YE4-112M-4	1455	91.1	0.80	26.3	2.7	3.3	9.5	59
YE4-132S-4	1460	91.9	0.80	36.0	2.7	3.6	9.5	86
YE4-132M-4	1460	92.6	0.81	49.1	2.8	3.6	9.5	101
YE4-160M-4	1475	93.3	0.83	71.2	2.8	3.3	9.5	124
YE4-160L-4	1480	93.9	0.84	96.8	2.8	3.3	9.5	145
YE4-180M-4	1480	94.2	0.85	119	2.5	3.4	9.5	197
YE4-180L-4	1480	94.5	0.85	142	2.6	2.7	9.5	216
YE4-200L-4	1480	94.9	0.85	194	2.8	3.5	9.0	302
YE4-225S-4	1480	95.2	0.85	239	3.0	3.3	9.0	333
YE4-225M-4	1480	95.4	0.85	290	3.2	3.5	9.0	359
YE4-250M-4	1485	95.7	0.86	354	3.0	3.1	9.0	492
YE4-280S-4	1485	96.0	0.87	482	2.5	2.8	8.5	622
YE4-280M-4	1485	96.1	0.88	579	2.5	2.8	8.5	710
YE4-315S-4	1485	96.3	0.89	707	2.5	2.7	8.5	872
YE4-315M-4	1485	96.4	0.89	849	2.5	2.8	8.5	990
YE4-315L1-4	1485	96.6	0.90	1029	2.3	2.7	8.5	1074
YE4-315L2-4	1485	96.7	0.90	1286	2.1	2.5	8.5	1234
YE4-355M-4	1490	96.7	0.90	1602	2.1	2.5	8.5	1771
YE4-355L-4	1490	96.7	0.90	2019	2.3	2.5	8.5	1878

技术参数 TECHNICAL DATA

IE4

型号 Model	额定功率 Rated Power		额定电流 Rated Current (A)								
	kW	HP	220V	380V	660V	230V	400V	690V	240V	415V	720V
YE4-90S-6	0.75	1	3.40	1.97	1.13	3.25	1.87	1.08	3.12	1.80	1.04
YE4-90L-6	1.1	1.5	4.88	2.83	1.63	4.67	2.68	1.56	4.47	2.59	1.49
YE4-100L-6	1.5	2	6.45	3.74	2.15	6.17	3.55	2.06	5.92	3.42	1.97
YE4-112M-6	2.2	3	9.30	5.39	3.10	8.90	5.12	2.97	8.53	4.93	2.84
YE4-132S-6	3	4	12.5	7.25	4.17	12.0	6.88	3.99	11.5	6.63	3.82
YE4-132M1-6	4	5.5	16.3	9.43	5.43	15.6	8.96	5.19	14.9	8.64	4.98
YE4-132M2-6	5.5	7.5	22.2	12.8	7.38	21.2	12.2	7.06	20.3	11.7	6.77
YE4-160M-6	7.5	10	28.4	16.4	9.46	27.1	15.6	9.04	26.0	15.0	8.67
YE4-160L-6	11	15	40.6	23.5	13.5	38.9	22.3	13.0	37.2	21.5	12.4
YE4-180L-6	15	20	53.0	30.7	17.7	50.7	29.1	16.9	48.6	28.1	16.2
YE4-200L1-6	18.5	25	65.0	37.6	21.7	62.2	35.7	20.7	59.6	34.4	19.9
YE4-200L2-6	22	30	76.1	44.0	25.4	72.8	41.8	24.3	69.7	40.3	23.2
YE4-225M-6	30	40	102	59.0	34.0	97.5	56.1	32.5	93.4	54.0	31.1
YE4-250M-6	37	50	124	71.7	41.3	118	68.1	39.5	113	65.6	37.8
YE4-280S-6	45	60	150	86.9	50.0	144	82.6	47.9	138	79.6	45.9
YE4-280M-6	55	75	181	105	60.2	173	99.4	57.6	166	95.8	55.2
YE4-315S-6	75	100	246	142	81.9	235	135	78.3	225	130	75.1
YE4-315M-6	90	125	291	168	97	278	160	92.7	266	154	88.8
YE4-315L1-6	110	150	355	205	118	339	195	113	325	188	108
YE4-315L2-6	132	180	420	243	140	401	231	134	385	222	128
YE4-355M1-6	160	220	508	294	169	485	279	162	465	269	155
YE4-355M2-6	200	270	634	367	211	606	349	202	581	336	194
YE4-355L-6	250	340	791	458	264	756	435	252	725	419	242

YE4-100L1-8	0.75	1	3.80	2.20	1.27	3.64	2.09	1.21	3.49	2.02	1.16
YE4-100L2-8	1.1	1.5	5.33	3.09	1.78	5.10	2.93	1.70	4.89	2.83	1.63
YE4-112M-8	1.5	2	6.91	4.00	2.30	6.61	3.80	2.20	6.33	3.66	2.11
YE4-132S-8	2.2	3	9.76	5.65	3.25	9.34	5.37	3.11	8.95	5.17	2.98
YE4-132M-8	3	4	13.1	7.58	4.36	12.5	7.20	4.17	12.0	6.94	4.00
YE4-160M1-8	4	5.5	17.0	9.83	5.66	16.2	9.34	5.41	15.6	9.00	5.19
YE4-160M2-8	5.5	7.5	22.7	13.1	7.57	21.7	12.5	7.24	20.8	12.0	6.94
YE4-160L-8	7.5	10	29.8	17.2	9.93	28.5	16.4	9.50	27.3	15.8	9.10
YE4-180L-8	11	15	43.2	25.0	14.4	41.3	23.7	13.8	39.6	22.9	13.2
YE4-200L-8	15	20	57.6	33.3	19.2	55.1	31.7	18.4	52.8	30.5	17.6
YE4-225S-8	18.5	25	70.6	40.9	23.5	67.5	38.8	22.5	64.7	37.4	21.6
YE4-225M-8	22	30	82.5	47.8	27.5	78.9	45.4	26.3	75.6	43.7	25.2
YE4-250M-8	30	40	110	63.9	36.8	106	60.7	35.2	101	58.5	33.7
YE4-280S-8	37	50	134	77.4	44.6	128	73.5	42.6	123	70.9	40.9
YE4-280M-8	45	60	162	93.9	54.0	155	89.2	51.7	149	85.9	49.5
YE4-315S-8	55	75	193	111	64.2	184	106	61	177	102	58.8
YE4-315M-8	75	100	261	151	87.1	250	144	83	239	138	79.8
YE4-315L1-8	90	125	309	179	103	295	170	98	283	164	94.4
YE4-315L2-8	110	150	376	218	125	360	207	120	345	200	115
YE4-355M1-8	132	180	451	261	150	431	248	144	413	239	138
YE4-355M2-8	160	220	538	312	179	515	296	172	494	285	165
YE4-355L-8	200	270	671	388	224	642	369	214	615	356	205

技术参数 TECHNICAL DATA

IE4

型号 Model	额定 转速 Speed	效率 Eff.	功率 因数 PF.	额定 转矩 Tn	堵转转矩 额定转矩 Tst/Tn	最大转矩 额定转矩 Tmax/Tn	堵转电流 额定电流 Ist/In	净重 N.G
	rpm	η(%)	cosφ	N.m				kg
YE4-90S-6	955	82.7	0.70	7.50	2.1	2.4	6.0	27
YE4-90L-6	955	84.5	0.70	11.0	2.1	2.4	6.5	32
YE4-100L-6	960	85.9	0.71	14.9	2.2	2.6	6.5	41
YE4-112M-6	965	87.4	0.71	21.8	2.2	2.6	7.5	58
YE4-132S-6	968	88.6	0.71	29.6	2.5	3.0	7.8	73
YE4-132M1-6	968	89.5	0.72	39.5	2.3	2.6	8.0	82
YE4-132M2-6	968	90.5	0.72	54.3	2.3	2.6	9.0	99
YE4-160M-6	975	91.3	0.76	73.5	2.4	3.0	8.0	134
YE4-160L-6	980	92.3	0.77	107	2.2	2.5	8.5	157
YE4-180L-6	980	92.9	0.80	146	2.2	2.6	8.5	189
YE4-200L1-6	980	93.4	0.80	180	2.2	2.5	8.5	254
YE4-200L2-6	980	93.7	0.81	214	2.4	2.8	8.5	273
YE4-225M-6	985	94.2	0.82	291	2.4	2.6	8.3	310
YE4-250M-6	985	94.5	0.83	359	2.1	2.3	8.3	430
YE4-280S-6	985	94.8	0.83	436	2.0	2.3	8.5	502
YE4-280M-6	985	95.1	0.84	533	2.0	2.3	8.5	558
YE4-315S-6	985	95.4	0.84	727	2.0	2.3	8.0	890
YE4-315M-6	985	95.6	0.85	873	2.0	2.2	8.0	999
YE4-315L1-6	985	95.8	0.85	1066	2.2	2.6	8.0	1096
YE4-315L2-6	985	96.0	0.86	1280	2.2	2.4	8.0	1209
YE4-355M1-6	990	96.2	0.86	1543	2.0	2.2	8.0	1612
YE4-355M2-6	990	96.3	0.86	1929	2.0	2.2	8.0	1772
YE4-355L-6	990	96.5	0.86	2412	2.0	2.2	8.0	2031

YE4-100L1-8	710	78.4	0.66	10.1	2.0	2.0	7.0	41
YE4-100L2-8	710	80.8	0.67	14.8	2.0	2.0	7.0	45
YE4-112M-8	710	82.6	0.69	20.2	2.0	2.0	7.0	58
YE4-132S-8	720	84.5	0.70	29.2	1.8	2.0	7.5	69
YE4-132M-8	720	85.9	0.70	39.8	1.8	2.0	7.8	81
YE4-160M1-8	720	87.1	0.71	53.1	1.8	2.0	7.9	134
YE4-160M2-8	720	88.3	0.72	73.0	1.8	2.0	8.1	147
YE4-160L-8	720	89.3	0.74	99.5	1.8	2.0	7.8	170
YE4-180L-8	725	90.4	0.74	145	1.8	2.0	7.9	201
YE4-200L-8	730	91.2	0.75	196	1.8	2.0	8.0	273
YE4-225S-8	730	91.7	0.75	242	1.8	2.0	8.1	287
YE4-225M-8	730	92.1	0.76	288	1.8	2.0	8.3	319
YE4-250M-8	730	92.7	0.77	392	1.8	2.0	7.9	430
YE4-280S-8	735	93.1	0.78	481	1.8	2.0	7.9	539
YE4-280M-8	735	93.4	0.78	585	1.8	2.0	7.9	622
YE4-315S-8	735	93.7	0.80	715	1.6	2.0	8.2	890
YE4-315M-8	740	94.2	0.80	968	1.6	2.0	7.6	999
YE4-315L1-8	740	94.4	0.81	1161	1.6	2.0	7.7	1096
YE4-315L2-8	740	94.7	0.81	1420	1.6	2.0	7.7	1209
YE4-355M1-8	742	94.9	0.81	1699	1.6	2.0	7.7	1612
YE4-355M2-8	742	95.1	0.82	2059	1.6	2.0	7.7	1772
YE4-355L-8	745	95.4	0.82	2564	1.6	2.0	7.8	2031



# TYT4系列铸铁壳三相永磁同步电动机

## TYT4 SERIES CAST IRON THREE PHASE PERMANENT MAGNET SYNCHRONOUS MOTOR

IE4



### 产品简介

该系列电动机设计符合 IEC 国际标准，可广泛应用于工业、商业和民用各种等需要高效节能设备的领域。

### 产品特点

- 功率范围：5.5~250kW
- 机座号：100~280
- 额定电压：380V
- 额定频率：50~200Hz
- 能效等级：IE4（国标能效二级）以上
- 绝缘等级：F
- 防护等级：IP55
- 冷却方式：IC411
- 工作制：S1
- 安装方式：B3、B35、B5

### 产品优势

- 体积小、重量轻
- 低噪音
- 起动转矩大
- 高效节能
- 安装便捷，维护方便
- 可靠耐用



www.ablecn.com

### PRODUCT INTRODUCTION

This series of motor design conforms to IEC standard. It could be widely used in the industry, commerce, residential fields that require high efficiency equipment.

### PRODUCT FEATURES

- Output: 5.5~250kW
- Frame size: 100~280
- Rated voltage: 380V
- Rated frequency: 50~200Hz
- Efficiency: IE4 (GB-grade 2), or higher
- Insulation class: F
- Protection grade: IP55
- Cooling method: IC411
- Duty type: S1
- Installation method: B3, B35, B5

### PRODUCT ADVANTAGE

- Compact size and light weight
- Low noise
- High starting torque
- High efficiency and energy saving
- Easy installation and maintenance
- Reliable and durable

### 技术参数 TECHNICAL DATA

IE4

型号 Model	额定功率 Rated Power		额定电压 Rated Voltage	额定频率 Frequency	额定转速 Speed	接法 Conn.	功率因素 Power factor	效率 Efficiency	额定电流 Rated Curr.	额定转矩 Tn
	KW	HP	V	Hz	rpm		cosφ	%	A	N.m
TYT4-100L1-6	5.5	7.5	380	150	3000	Y	0.97	90.9	10.0	17.5
TYT4-100L2-6	7.5	10	380	150	3000	Y	0.97	91.7	13.5	23.9
TYT4-112M-6	11	15	380	150	3000	Y	0.97	92.6	19.6	35
TYT4-132S1-6	15	20	380	150	3000	Y	0.97	93.3	26.5	47.8
TYT4-132S2-6	18.5	25	380	150	3000	Y	0.97	93.7	32.6	58.9
TYT4-132M-6	22	30	380	150	3000	Y	0.97	94.0	38.6	70
TYT4-160M1-6	30	40	380	150	3000	Y	0.97	94.5	52.3	95.5
TYT4-160M2-6	37	50	380	150	3000	Y	0.97	94.8	64.4	118
TYT4-160L-6	45	60	380	150	3000	Y	0.97	95.0	78.1	143
TYT4-180M-6	55	75	380	150	3000	Y	0.97	95.3	95.2	175
TYT4-180L-6	75	100	380	150	3000	Y	0.97	95.6	129	239
TYT4-200L1-6	90	125	380	150	3000	Y	0.97	95.8	155	286
TYT4-200L2-6	110	150	380	150	3000	Y	0.97	96.0	189	350
TYT4-225M-6	132	180	380	150	3000	Y	0.97	96.2	226	420
TYT4-250M1-6	160	220	380	150	3000	Y	0.97	96.3	274	509
TYT4-250M2-6	200	270	380	150	3000	Y	0.97	96.5	342	637
TYT4-280M-6	250	340	380	150	3000	Y	0.97	96.5	427	796
TYT4-100L1-8	3	4	380	100	1500	Y	0.97	90.4	5.50	19.1
TYT4-100L2-8	4	5.5	380	100	1500	Y	0.97	91.1	7.20	25.5
TYT4-112M-8	5.5	7.5	380	100	1500	Y	0.97	91.9	9.90	35
TYT4-132S-8	7.5	10	380	100	1500	Y	0.97	92.6	13.4	47.8
TYT4-132M-8	11	15	380	100	1500	Y	0.97	93.3	19.4	70
TYT4-160M1-8	15	20	380	100	1500	Y	0.97	93.9	26.3	95.5
TYT4-160M2-8	18.5	25	380	100	1500	Y	0.97	94.2	32.4	118
TYT4-160L-8	22	30	380	100	1500	Y	0.97	94.5	38.4	140
TYT4-180M-8	30	40	380	100	1500	Y	0.97	94.9	52.1	191
TYT4-180L-8	37	50	380	100	1500	Y	0.97	95.2	64.1	236
TYT4-200L1-8	45	60	380	100	1500	Y	0.97	95.4	77.8	286
TYT4-200L2-8	55	75	380	100	1500	Y	0.97	95.7	94.8	350
TYT4-225M-8	75	100	380	100	1500	Y	0.97	96.0	129	477
TYT4-250M1-8	90	125	380	100	1500	Y	0.97	96.1	154	573
TYT4-250M2-8	110	150	380	100	1500	Y	0.97	96.3	188	700
TYT4-280S-8	132	180	380	100	1500	Y	0.97	96.4	226	840
TYT4-280M-8	160	220	380	100	1500	Y	0.97	96.6	273	1019
TYT4-280S-8*	90	125	380	66.7	1000	Y	0.98	95.6	154	859.5
TYT4-280M1-12*	110	150	380	100	1000	Y	0.98	96.0	187	1050
TYT4-280M2-12*	132	180	380	100	1000	Y	0.98	96.0	224	1260
TYT4-250M1-12*	60	80	380	80	800	Y	0.97	95.1	104	716
TYT4-250M2-12*	75	100	380	80	800	Y	0.98	96.0	128	895.3

### IMB3

### IMB35

### IMB5

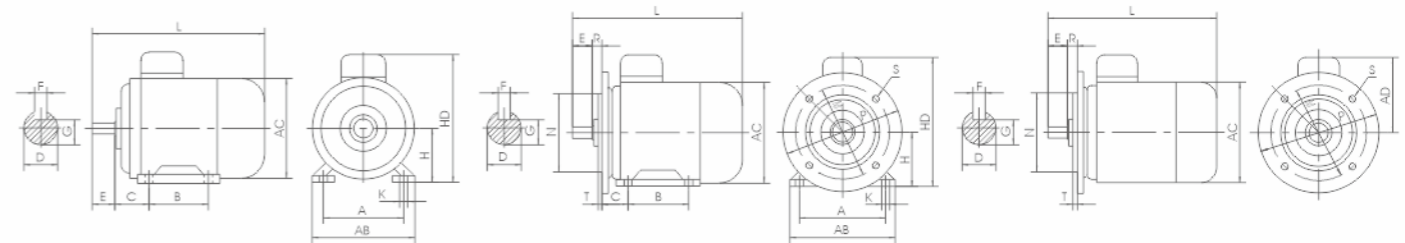

### 外形及安装尺寸 INSTALLATION AND OVERALL DIMENSIONS

机座号 Frame Size	转速 Speed rpm	安装尺寸 Mounting Dimensions(mm)													外形尺寸 Overall Dimensions(mm)						
		A	B	C	D	E	F	G	H	K	M	N	P	R	S	T	AB	AC	AD	HD	L
100L		160	140	63	28	60	8	24	100	12	215	180	250	0	4-14.5	4	200	206	181	281	428
112M		190	140	70	28	60	8	24	112	12	215	180	250	0	4-14.5	4	226	220	188	300	395
132S		216	140	89	38	80	10	33	132	12	265	230	300	0	4-14.5	4	262	259	208	340	463
132M		216	178	89	38	80	10	33	132	12	265	230	300	0	4-14.5	4	262	259	208	340	501
160M	3000	254	210	108	42	110	12	37	160	14.5	300	250	350	0	4-18.5	5	314	314	264	424	610
160L	1500	254	254	108	42	110	12	37	160	14.5	300	250	350	0	4-18.5	5	314	314	264	424	654
180M		279	241	121	48	110	14	42.5	180	14.5	300	250	350	0	4-18.5	5	349	354	283	463	686
180L		279	279	121	48	110	14	42.5	180	14.5	300	250	350	0	4-18.5	5	349	354	283	463	724
200L		318	305	133	55	110	16	49	200	18.5	350	300	400	0	4-18.5	5	388	396	312	512	769
225S	1500	356	286	149	60	140	18	53	225	18.5	400	350	450	0	8-18.5	5	431	445	333	558	823
225M	3000	356	311	149	55	110	16	49	225	18.5	400	350	450	0	8-18.5	5	431	445	333	558	818
225M	1500	356	311	149	60	140	18	53	225	18.5	400	350	450	0	8-18.5	5	431	445	333	558	848
250M	3000	406	349	168	60	140	18	53	250	24	500	450	550	0	8-18.5	5	484	484	367	617	909
250M	1500	406	349	168	65	140	18	58	250	24	500	450	550	0	8-18.5	5	484	484	367	617	909
280S	3000	457	368	190	65	140	18	58	280	24	500	450	550	0	8-18.5	5	542	546	396	676	959
280S	1500	457	368	190	75	140	20	67.5	280	24	500	450	550	0	8-18.5	5	542	546	396	676	979
280M	3000	457	419	190	65	140	18	58	280	24	500	450	550	0	8-18.5	5	542	546	396	676	1010
280M	1500	457	419	190	75	140	20	67.5	280	24	500	450	550	0	8-18.5	5	542	546	396	676	1030

# YD系列铸铁壳变极多速三相异步电动机

## YD SERIES CAST IRON VARIABLE POLE MULTI-SPEED THREE PHASE INDUCTION MOTOR

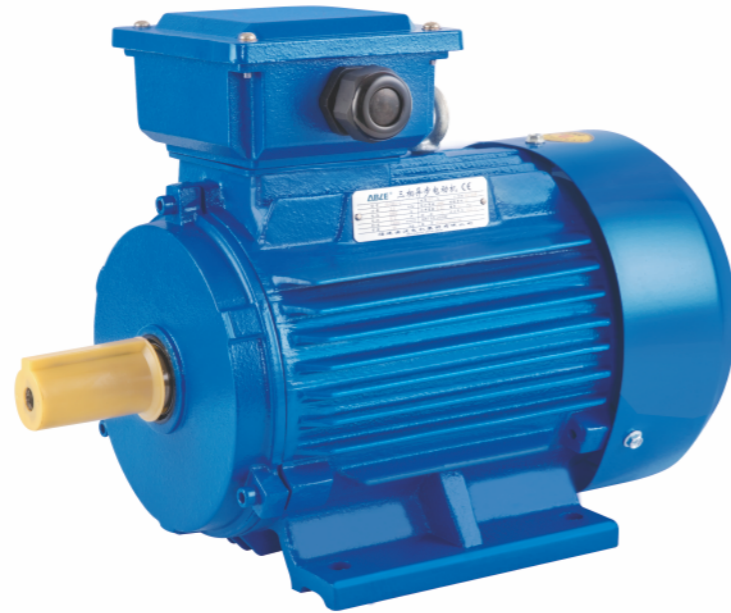

### 产品简介

YD系列电动机主要用于需要变极调速的各种机床上，其电压，频率，安装结构及外形尺寸，绝缘等级，冷却方式均与Y2HE系列相同。

### 使用条件

- 绝缘等级: F
- 防护等级: IP54/IP55
- 额定电压: 根据客户需求
- 额定频率: 50Hz/60Hz
- 冷却方式: IC411
- 工作制: S1

### 安装结构

- B3机座带底脚，端盖无凸缘
- B35机座带底脚，端盖有凸缘
- B5机座无底脚，端盖有凸缘

### PRODUCT INTRODUCTION

YD series motors are mainly used in various machine tools which need variable pole speed regulation. Their voltage, frequency, installation mode, shape size, insulation level and cooling mode are the same as Y2HE series.

### APPLICATION CONDITIONS

- Insulation grade: F
- Protection grade: IP54/IP55
- Rated voltage according to customer's request
- Rated frequency: 50Hz/60Hz
- Cooling method: IC411
- Duty type: S1

### INSTALLATION STRUCTURE

- B3 base with feet; end shields without flange
- B35 base with feet; end shields with flange
- B5 base without feet; end shields with flange



www.ablecn.com

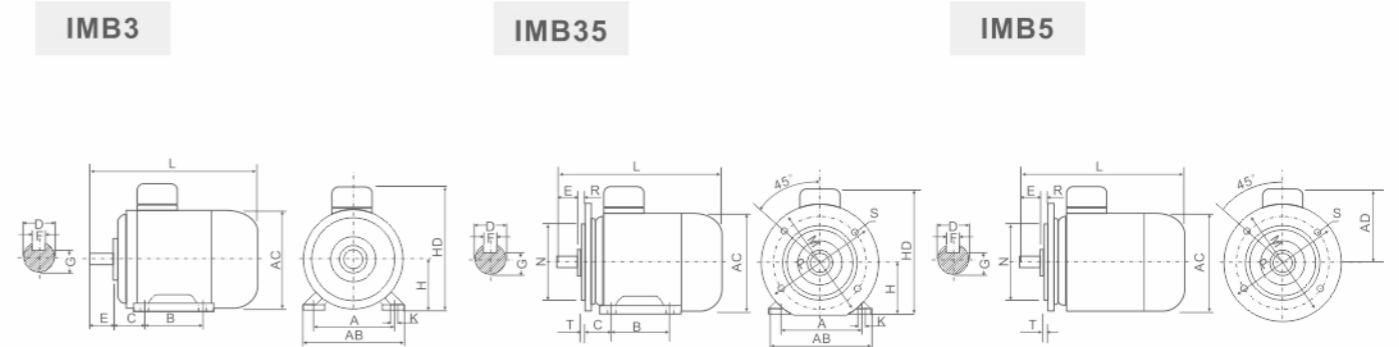

### 外形及安装尺寸 INSTALLATION AND OVERALL DIMENSIONS

机座号 Frame Size	安装尺寸 Mounting Dimensions (mm)																外形尺寸 Overall Dimensions(mm)								
	A	B	C	D		E		F		G		H	K	M	N	P	R	S	T	AB	AC	AD	HD	L	
				2P	4,6,8,10P	2P	4,6,8,10P	2P	4,6,8,10P	2P	4,6,8,10P													2P	4,6,8,10P
80	125	100	50	19	40	6	15.5	80	10	165	130	200	0	12	3.5	165	175	145	220	295					
90S	140	100	56	24	50	8	20	90	10	165	130	200	0	12	3.5	180	195	155	250	320					
90L	140	125	56	24	50	8	20	90	10	165	130	200	0	12	3.5	180	195	155	250	345					
100L	160	140	63	28	60	8	24	100	12	215	180	250	0	15	4	205	215	180	270	385					
112M	190	140	70	28	60	8	24	112	12	215	180	250	0	15	4	230	240	190	300	400					
132S	216	140	89	38	80	8	33	132	12	265	230	300	0	15	4	270	275	210	345	470					
132M	216	178	89	38	80	10	33	132	12	265	230	300	0	15	4	270	275	210	345	510					
160M	254	210	108	42	110	12	37	160	15	300	250	350	0	19	5	315	330	255	400	605					
160L	254	254	108	42	110	12	37	160	15	300	250	350	0	19	5	315	330	255	400	660					
180M	279	241	121	48	110	14	42.5	180	15	300	250	350	0	19	5	355	380	280	440	690					
180L	279	279	121	48	110	14	42.5	180	15	300	250	350	0	19	5	355	380	280	440	725					
200L	318	305	133	55	110	16	49	200	19	350	300	400	0	19	5	410	420	305	500	765					
225S	356	286	149	60	140	18	53	225	19	400	350	450	0	19	5	445	470	335	555	810					
225M	356	311	149	60	110	140	16	18	49	53	225	19	400	350	450	0	19	5	445	470	335	550	805	835	
250M	406	349	168	65	140	18	53	58	250	24	500	450	550	0	19	5	485	510	370	615	910				
280S	457	368	190	75	140	18	58	67.5	280	24	500	450	550	0	19	5	550	580	410	660	980				
280M	457	419	190	75	140	18	58	67.5	280	24	500	450	550	0	19	5	550	580	410	660	1030				
315S	508	406	216	80	140	170	18	22	58	71	315	28	600	550	660	0	24	6	630	645	630	825	1180	1275	
315M	508	457	216	80	140	170	18	22	58	71	315	28	600	550	660	0	24	6	630	645	630	830	1290	1320	
315L	508	508	216	80	140	170	18	22	58	71	315	28	600	550	660	0	24	6	630	645	630	830	1290	1320	
355M	610	560	254	95	140	170	20	25	68	86	355	28	740	680	800	0	24	6	705	710	655	1010	1510	1540	
355L	610	630	254	95	140	170	20	25	68	86	355	28	740	680	800	0	24	6	705	710	655	1010	1510	1540	

技术参数 TECHNICAL DATA

型号 Model	极数 Polar number	额定功率 Rated Power	满载时 Full load				堵转电流 额定电流 Ist/In	堵转转矩 额定转矩 Tst/Tn	最大转矩 额定转矩 Tmax/Tn	电机重量 N.G
			转速	电流	效率	功率因数				
			Speed	Current	Eff.	PF				
		kW	rpm	A	η(%)	cosφ			kg	
YD801-4/2	4	0.45	1420	1.4	66	0.74	6.5	1.5	17	
	2	0.55	2860	1.5	65	0.85	7	1.7		
YD802-4/2	4	0.55	1420	1.7	68	0.74	6.5	1.6	18	
	2	0.75	2860	2	66	0.85	7	1.8		
YD90S-4/2	4	0.85	1430	2.3	74	0.77	6.5	1.8	22	
	2	1.1	2850	2.8	71	0.85	7	1.9		
YD90L-4/2	4	1.3	1430	3.3	76	0.78	6.5	1.8	27	
	2	1.8	2850	4.3	73	0.85	7	2		
YD100L1-4/2	4	2	1430	4.8	78	0.81	6.5	1.7	34	
	2	2.4	2850	5.6	76	0.86	7	1.9		
YD100L2-4/2	4	2.4	1450	5.6	79	0.83	6.5	1.6	38	
	2	3	2890	6.7	77	0.89	7	1.7		
YD112M-4/2	4	3.3	1450	7.4	82	0.83	6.5	1.9	43	
	2	4	2860	8.6	79	0.889	7	2		
YD132S-4/2	4	4.5	1450	9.8	83	0.84	6.5	1.7	68	
	2	5.5	2860	11.9	79	0.89	7	1.8		
YD132M-4/2	4	6.5	1450	13.8	84	0.85	6.5	1.7	81	
	2	8	2880	17.1	80	0.89	7	1.8		
YD160M-4/2	4	9	1460	18.5	87	0.85	6.5	1.6	123	
	2	11	2920	22.9	82	0.89	7	1.8		
YD160L-4/2	4	11	1460	23.3	87	0.86	6.5	1.7	144	
	2	14	2920	28.8	82	0.9	7	1.9		
YD180M-4/2	4	15	1470	29.4	89	0.87	6.5	1.8	182	
	2	18.5	2940	36.7	85	0.9	7	1.9		
YD180L-4/2	4	18.5	1470	35.9	89	0.88	6.5	1.6	190	
	2	22	2940	42.7	86	0.91	7	1.8		
YD200L-4/2	4	26	1470	49.9	89	0.89	6.5	1.4	270	
	2	30	2950	58.3	85	0.92	7	1.6		
YD225S-4/2	4	32	1480	60.7	90	0.89	6.5	1.4	290	
	2	37	2960	71.1	86	0.92	7	1.6		
YD225M-4/2	4	37	1480	69.4	91	0.89	6.5	1.6	325	
	2	45	2960	86.4	86	0.92	7	1.6		
YD250M-4/2	4	45	1480	84.4	91	0.89	6.5	1.6	427	
	2	52	2960	98.7	87	0.92	7	1.6		
YD280S-4/2	4	60	1490	111.3	91	0.9	6.5	1.4	565	
	2	72	2970	135.1	88	0.92	7	1.5		
YD280M-4/2	4	72	1480	133.6	91	0.9	6.5	1.4	667	
	2	82	2970	152.2	88	0.93	7	1.5		
YD90S-6/4	6	0.65	920	2.2	64	0.68	6	1.6	23	
	4	0.85	1420	2.3	70	0.79	6.5	1.4		
YD90L-6/4	6	0.85	930	2.8	66	0.79	6	1.6	25	
	4	1.1	1400	3	71	0.7	6.5	1.5		
YD100L1-6/4	6	1.3	940	3.8	74	0.8	6	1.7	34	
	4	1.8	1440	4.4	77	0.7	6.5	1.4		
YD100L2-6/4	6	1.5	940	4.3	75	0.8	6	1.6	38	
	4	2.2	1440	6.4	77	0.75	6.5	1.4		
YD112M-6/4	6	2.2	960	5.7	78	0.82	6	1.8	49	
	4	2.8	1440	6.7	77	0.75	6.5	1.5		
YD132S-6/4	6	3	970	7.7	79	0.82	6	1.8	65	
	4	4	1440	9.5	78	0.76	6.5	1.7		
YD132M-6/4	6	4	970	9.8	80	0.85	6	1.6	84	
	4	5.5	1440	12.3	82	0.78	6.5	1.4		
YD160M-6/4	6	6.5	970	15.1	84	0.85	6	1.5	119	
	4	8	1440	17.6	82	0.76	6.5	1.5		
YD160L-6/4	6	9	970	20.6	85	0.85	6	1.6	147	
	4	11	1440	23.7	83	0.78	6.5	1.7		
YD180M-6/4	6	11	980	25.9	85	0.85	6	1.6	192	
	4	14	1470	29.8	84	0.78	6.5	1.7		
YD180L-6/4	6	13	980	29.4	86	0.86	6	1.7	224	
	4	16	1470	33.6	85	0.85	6.5	1.7		
YD200L-6/4	6	18.5	980	41.4	87	0.78	6.5	1.6	200	
	4	22	1460	44.9	86.5	0.86	7	1.5		
YD225S-6/4	6	22	980	44.2	88	0.86	6.5	1.8	290	
	4	28	1470	56.5	86.5	0.87	7	1.8		
YD225M-6/4	6	26	980	52.2	88	0.86	6.5	1.8	305	
	4	32	1470	63.2	85.5	0.9	7	1.8		
YD250M-6/4	6	32	980	62.1	90	0.87	6.5	1.5	420	
	4	42	1480	81.1	86.5	0.91	7	1.3		
YD280S-6/4	6	42	980	81.5	90	0.87	6.5	1.5	550	
	4	55	1470	106.7	87	0.9	7	1.3		
YD280M-6/4	6	55	980	106.7	90	0.87	6.5	1.6	610	
	4	67	1470	131.5	87	0.89	7	1.3		

型号 Model	极数 Polar number	额定功率 Rated Power	满载时 Full load				堵转电流 额定电流 Ist/In	堵转转矩 额定转矩 Tst/Tn	最大转矩 额定转矩 Tmax/Tn	电机重量 N.G
			转速	电流	效率	功率因数				
			Speed	Current	Eff.	PF				
		kW	rpm	A	η(%)	cosφ			kg	
YD90L-8/4	8	0.45	700	1.9	58	0.63	5.5	1.6	25	
	4	0.75	1420	1.8	72	0.87	6.5	1.4		
YD100L-8/4	8	0.85	700	3	67	0.63	5.5	1.6	38	
	4	1.5	1410	3.5	74	0.88	6.5	1.4		
YD112M-8/4	8	1.5	700	5	72	0.63	5.5	1.7	49	
	4	2.4	1410	5.3	78	0.88	6.5	1.7		
YD132S-8/4	8	2.2	720	7	75	0.64	5.5	1.5	63	
	4	3.3	1440	7.1	80	0.88	6.5	1.7		
YD132M-8/4	8	3	730	9	78	0.65	5.5	1.5	80	
	4	4.5	1450	9.4	82	0.89	6.5	1.6		
YD160M-8/4	8	5	730	13.9	83	0.66	5.5	1.5	124	
	4	7.5	1450	15.2	84	0.89	6.5	1.6		
YD160L-8/4	8	7	730	19	85	0.66	5.5	1.5	147	
	4	11	1450	21.8	86	0.89	6.5	1.6		
YD180L-8/4	8	11	730	26.7	87	0.72	6	1.5	259	
	4	17	1470	32.3	88	0.91	7	1.5		
YD200L1-8/4	8	14	740	33	87	0.74	6	1.8	260	
	4	22	1470	41.3	88	0.92	7	1.7		
YD200L2-8/4	8	17	740	40.1	87	0.74	6	1.5	275	
	4	26	1470	48.8	88	0.92	7	1.7		
YD225M-8/4	8	24	740	53.2	89	0.77	6	1.5	300	
	4	34	1470	66.7	88	0.88	7	1.5		
YD250M-8/4	8	30	740	64.9	90	0.78	6	1.6	420	
	4	42	1480	78.8	89	0.91	7	1.7		
YD280S-8/4	8	40	740	83.5	91	0.8	6	1.6	550	
	4	55	1480	102	90	0.91	7	1.7		
YD280M-8/4	8	47	740	96.9	91	0.81	6	1.6	615	
	4	67	1480	122.9	90	0.92	7	1.7		
YD90S-8/6	8	0.35	700	1.6	56	0.6	5	1.8	23	
	6	0.45	930	1.4	70	0.72	6	2		
YD90L-8/6	8	0.45	700	1.9	59	0.6	5	1.7	25	
	6	0.65	930	1.9	71	0.73	6	1.8		
YD100L-8/6	8	0.75	710	2.9	65	0.6	5	1.8	38	
	6	1.1	950	3.1	75	0.73	6	1.9		
YD112M-8/6	8	1.3	710	4.5	72	0.61	5	1.7	51	
	6	1.8	950	4.8	78	0.73	6	1.9		
YD132S-8/6	8	1.8	730	5.8	76	0.62	5	1.6	63	
	6	2.4	970	6.2	80	0.73	6	1.9		
YD132M-8/6	8	2.6	730	8.2	78	0.62	5	1.9	84	
	6	3.7	970	9.4	82	0.73	6	1.9		
YD160M-8/6	8	4.5	730	13.3	83	0.62	5	1.6	119	
	6	6	980	14.7	85	0.73	6	1.9		
YD160L-8/6	8	6	730	17.5	84	0.62	5	1.6	147	
	6	8	980	19.4	86	0.73	6	1.9		
YD180M-8/6	8	7.5	730	21.9	84	0.62	5	1.9	195	
	6	10	980	24.2	86	0.73	6	1.9		
YD180L-8/6	8	9	730	24.8	85	0.65	5	1.8	224	
	6	12	980	28.3	86	0.75	6	1.8		
YD200L1-8/6	8	12	730	32.5	85	0.66	5	1.8	230	
	6	17	980	39	86	0.77	6	2		
YD200L2-8/6	8	15	730	40.2	86	0.66	5	1.8	260	
	6	20	980	45.4	87	0.77	6	2		
YD160M-12/6	12	2.6	480	11.6	74	0.46	4	1.2	119	
	6	5	970	11.9	84	0.76	6	1.4		
YD160L-12/6	12	3.7	480	16.1	76	0.46	4	1.2	147	
	6	7	970	15.8	85	0.79	6	1.4		
YD180L-12/6	12	5.5	490	19.6	79	0.54	4	1.3	224	
	6	10	980	20.5	86	0.86	6	1.3		
YD200L1-12/6	12	7.5	490	24.5	83	0.56	4	1.5	260	
	6	13	970	26.4	87	0.86	6	1.5		
YD200L2-12/6	12	9	490	28.9	83	0.57	4	1.5	270	
	6	15	970	30.1	87	0.87	6	1.5		
YD225M-12/6	12	12	490	35.2	85	0.61	4	1.5	285	
	6	20	980	39.7	88	0.87	6	1.5		
YD250M-12/6	12	15	490	42.1	86	0.63	4	1.5	405	
	6	24	990	47.1	89	0.87	6	1.5		
YD280S-12/6	12	20	490	54.8	88	0.63	4	1.5	520	
	6	30	990	58.9	89	0.87	6	1.5		
YD280M-12/6	12	24	490	63.7	88	0.65	4	1.5	590	
	6	37	990	72.6	89	0.87	6	1.5		